

*TILTA*

CT08

---

CINE TRIPOD SERIES



Thank you for purchasing TILTA products.

Before using this product, please carefully read this document to ensure that the product has been set up correctly. The final interpretation of this document and all related documents for this product belongs to TILTA. For updates, please visit the official website at [www.tilta.com](http://www.tilta.com) for the latest product information. TILTA reserves the right to modify any information in this manual at any time without prior notice and without assuming any responsibility.

By using this product, you are deemed to have carefully read the disclaimer and warnings, understood, agreed, and accepted all the terms and content of this statement. You promise to take full responsibility for the use of this product and any consequences that may arise. You commit to using this product only for legitimate purposes and agree to these terms as well as any related regulations, policies, and guidelines set by TILTA.

TILTA is not responsible for any damages, injuries, or legal liabilities caused directly or indirectly by the use of this product. Users should follow all safety guidelines mentioned in this document, including but not limited to those mentioned.

Despite the above provisions, consumer rights are still protected by local laws and regulations and are not affected by this disclaimer.

TILTA is a trademark of Shenzhen TILTA Technology Co., Ltd. and its affiliated companies. Product names, brands, and other trademarks appearing in this document are trademarks or registered trademarks of their respective companies.

## SPECIFICATIONS

### ► [CT08 TRIPOD SYSTEM]

Material: Aluminum Alloy + Carbon Fiber

Weight: 4.5 KG

Folded Size: 158 × 135.5 × 749.5 mm

Minimum Height: 250 mm ; Maximum Height: 1800 mm

Operating Temperature: -50°C to 60°C

### ► [CT08 FLUID HEAD]

Material: Aluminum Alloy

Weight: 2.128 KG

Load Capacity: 8 KG

Size: 141 × 122 × 172 mm

Counterbalance: 8 Stops (1-8)

Drag: 4 Stops (1-4) vertical ; 4 Stops (1-4) horizontal

Tilt Angle: -60° to +90°

### ► [CT08 TRIPOD LEGS]

Material: Aluminum Alloy + Carbon Fiber

Weight: 2.3 KG

Tripod Legs Payload: 75 kg / 165 lbs at 22.5° (First Level) ; 12 kg / 26 lbs at 85° (Fourth Level)

Folded Size: 136 × 127 × 599 mm

Bowl Diameter: 75 mm Bowl

Leg Diameter: 36 mm / 32 mm / 28 mm / 24 mm

Minimum Height: 92 mm ; Maximum Height: 1681 mm

Leg Angle: 22.5° (First Level) / 43° (Second Level) / 63° (Third Level) / 85° (Fourth Level)

Special Features: High-strength carbon fiber single tube, buckle-type locking.

### ► [QUICK RELEASE PLATE TYPE]

Arca-Swiss / Manfrotto Dual Quick Release Plate

### ► [RECEIVING PLATFORM]

Arca-Swiss / Manfrotto Dual Receiver (Adjustable front to back, the platform can be removed and replaced with an 8-inch dovetail adapter.)



# 02 FLUID HEAD / TRIPOD

## [ARCA-SWISS QUICK RELEASE PLATE]

- 1 Anti-Slip Rubber Pad
- 2 1/4"-20 Thread
- 3 3/8"-16 Thread

## [FLUID HEAD]

- 4 Arca-Swiss/Manfrotto Dual Receiving Platform
  - a. Accommodates Arca-Swiss/Manfrotto Quick Release Plates
  - b. Adjustable front and back for balance adjustment
- 5 Bubble Level
- 6 Quick Release Plate Locking Knob
- 7 Tilt Locking Knob
  - Release / Lock Vertical Movement
- 8 Rosette (For Pan Arm)
- 9 4 Stops Vertical Drag Adjustment
  - a. Adjust the strength of vertical drag
  - b. 4 stops (1-4) of vertical drag adjustment
- 10 Pan Locking Knob
  - Release / Lock Horizontal Movement
- 11 Bubble Level
- 12 75mm Bowl Base
- 13 Safety Pin
- 14 Locking Lever for Receiving Platform
- 15 Pan Arm Locking Knob
- 16 Pan Arm
- 17 8 Stops Counterbalance
  - a. Adjust the counterbalance based on the weight of the camera
  - b. 8 stops (1-8) of counterbalance adjustment
- 18 4 Stops Horizontal Drag
  - a. Adjust the strength of horizontal drag
  - b. 4 stops (1-4) of horizontal drag adjustment
- 19 Threaded Bolt

## [CARBON FIBER SINGLE TUBE]

- 20 75 mm Bowl
- 21 Angle Adjustment Button
  - 4 positions of angle adjustment
- 22 Carbon Fiber Single Tube
- 23 1/4"-20 Thread with Locating Point

- 24 Tie Down

- 25 Leg Clamp
- 26 Locking Lever
- 27 Rotatable Rubber Feet
- 28 Retractable Spiked Feet
- 29 Hook

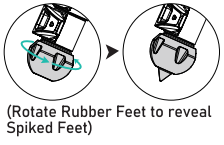
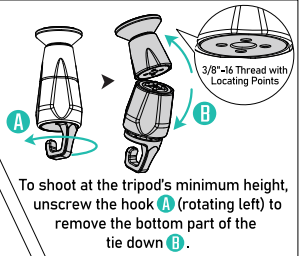

VERTICAL DRAG ADJUSTMENT

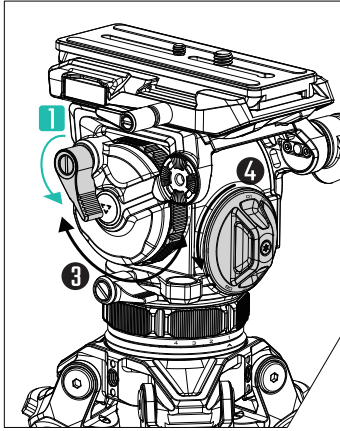

By releasing the tilt locking knob **1**, the fluid head enables a vertical movement from +90° to -60° **2**.

**Drag Adjustment**

By rotating the vertical drag adjustment **3**, users can modify the level of resistance for up to 4 stops (1-4).

**Counterbalance**

By rotating the counterbalance adjustment **4**, users can adjust the rebound force for up to 8 stops (1-8).

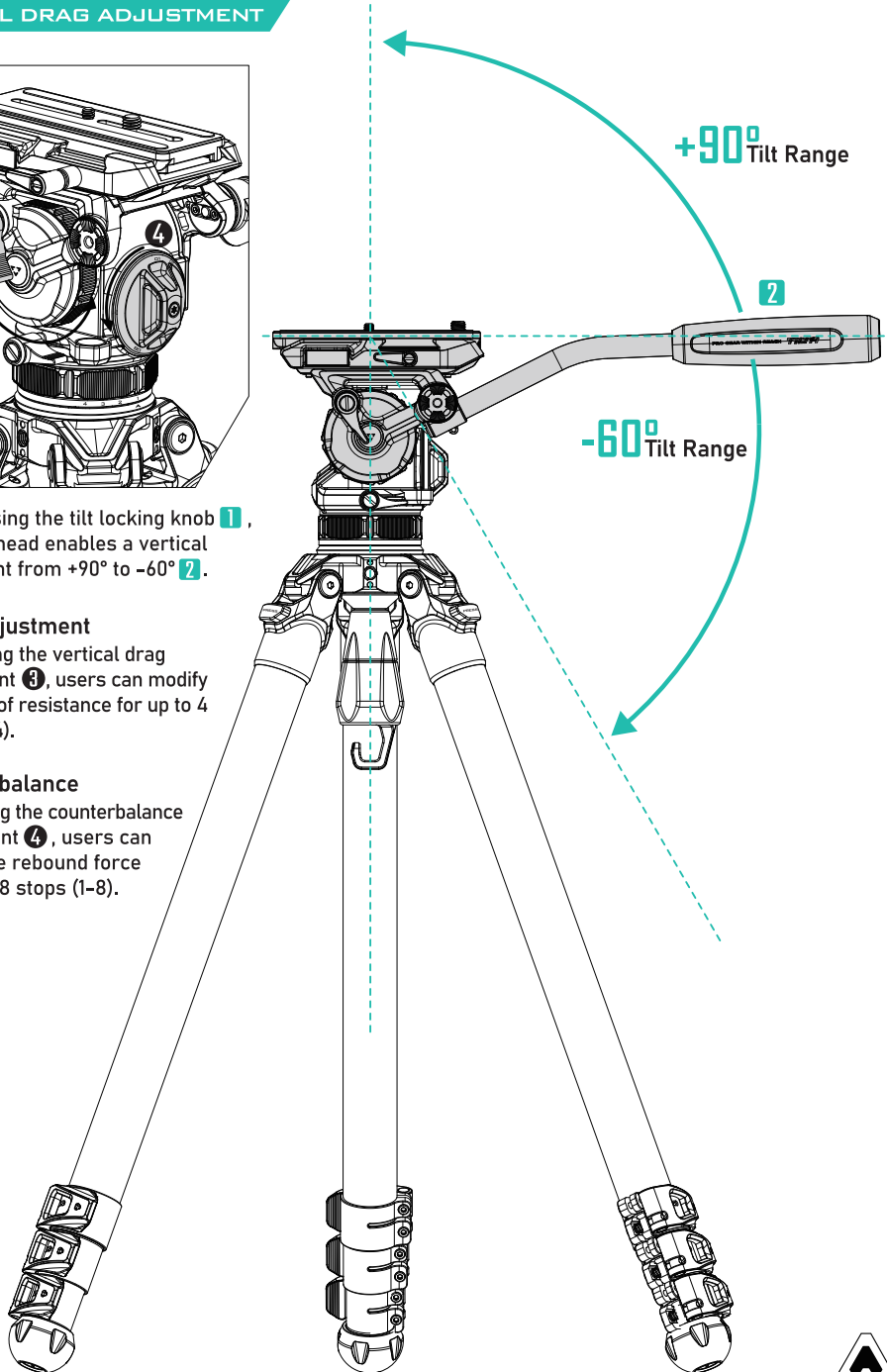

HORIZONTAL DRAG ADJUSTMENT

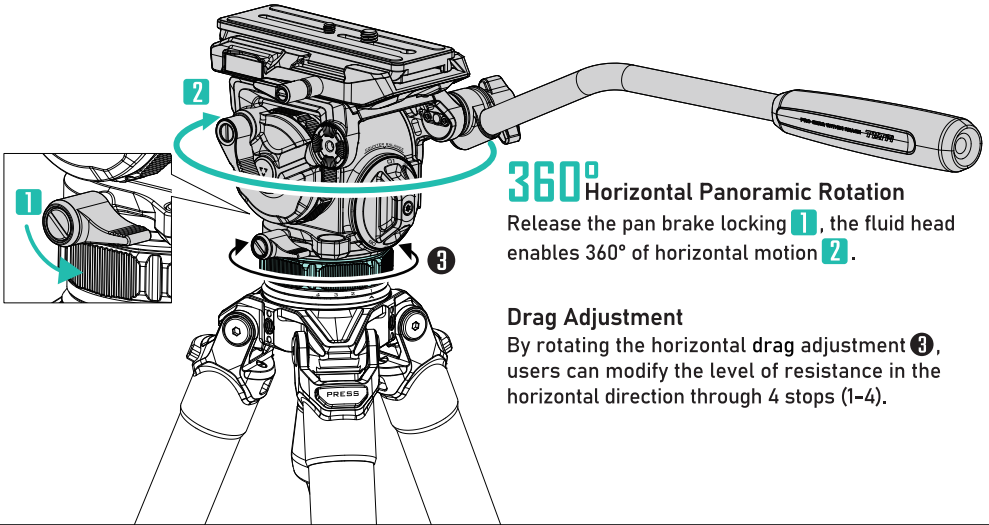

**360°** Horizontal Panoramic Rotation

Release the pan brake locking **1**, the fluid head enables 360° of horizontal motion **2**.

**Drag Adjustment**

By rotating the horizontal drag adjustment **3**, users can modify the level of resistance in the horizontal direction through 4 stops (1-4).

ADJUSTABLE FRONT AND BACK FOR BALANCE ADJUSTMENT



**Arca-Swiss / Manfrotto Dual Receiving Platform**

Adjust the locking lever **1**, the plate **2** can move forward and backward to adjust the balance of the camera's center of gravity.

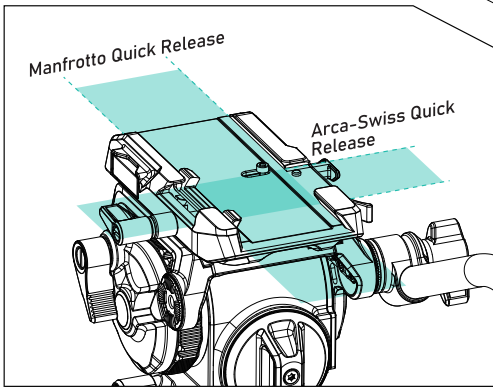

**Arca-Swiss / Manfrotto Dual Receiving Platform**  
Arca-Swiss / Manfrotto dual quick release

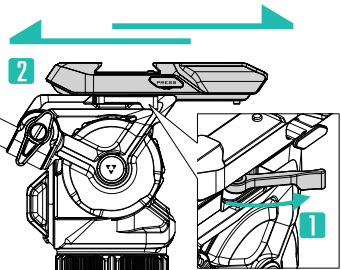

## 05 FLUID HEAD - INTRODUCTION (3)

### RECEIVING PLATFORM CAN BE REPLACED WITH TILTA DOVETAIL ADAPTER (OPTIONAL)

Adjust the plate's position, loosen the lever **1** and remove the M3 screw **2** under the plate, then remove the plate **3**.

Replace with an **4** 8" Arri Dovetail Adapter Plate for Tilta Cine Tripod (TT-ADA-8-SG) or 8" Tilta Standard Dovetail Tripod Adapter Plate (TA-TAP8-SG), slide it onto the fluid head, and tighten with the lever **5**.

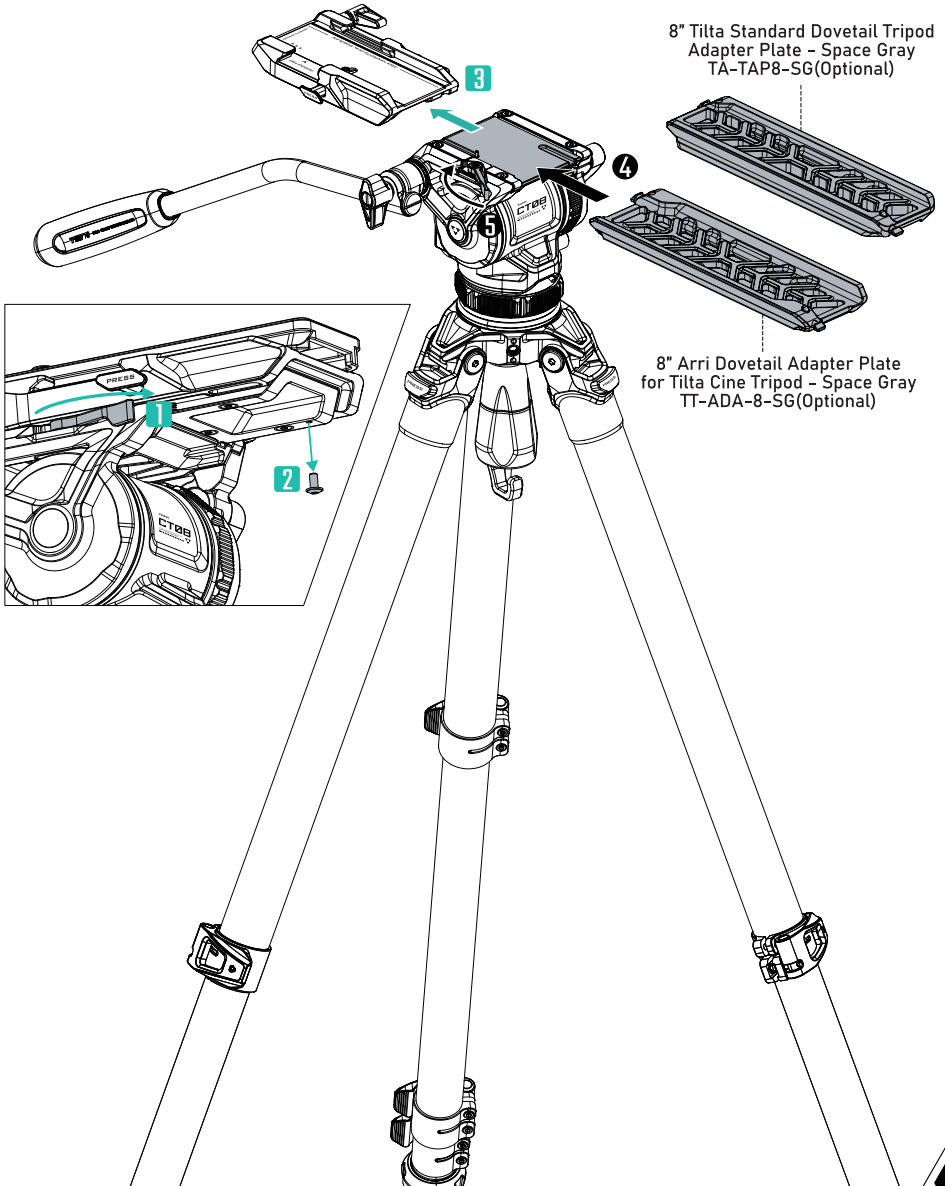

# 06 TRIPOD - INTRODUCTION

## FOUR-STOP LEG ANGLE ADJUSTMENT

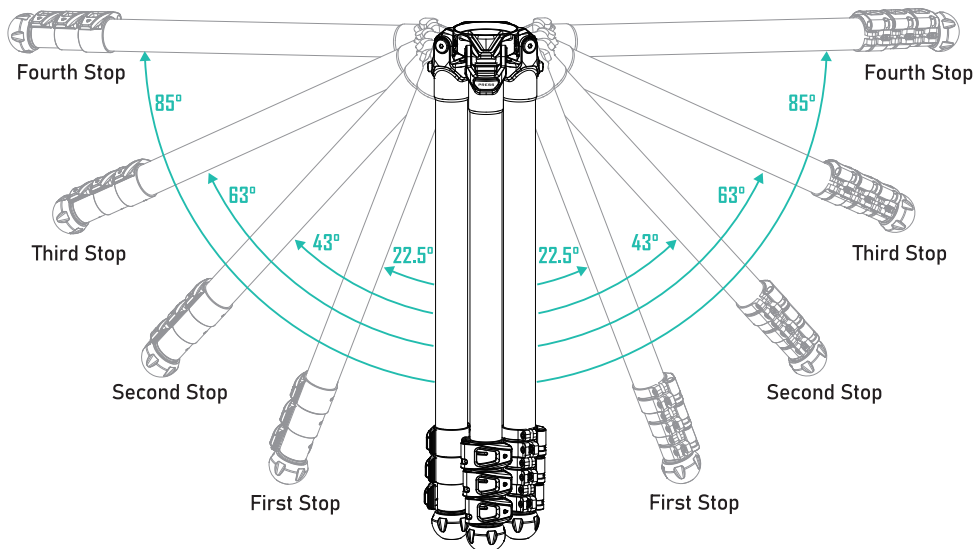

◀ When folded, the legs can be opened directly to the first position. ▶

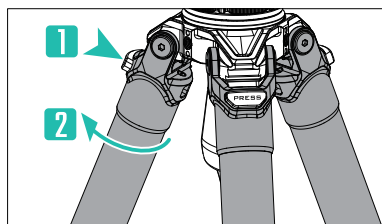

When the tripod is not supporting weight, hold the angle adjustment button **1** and lift the leg **2** simultaneously to complete the angle adjustment to the second, third, or fourth stop.

## EXTENDABLE LEG TUBE ADJUSTMENT

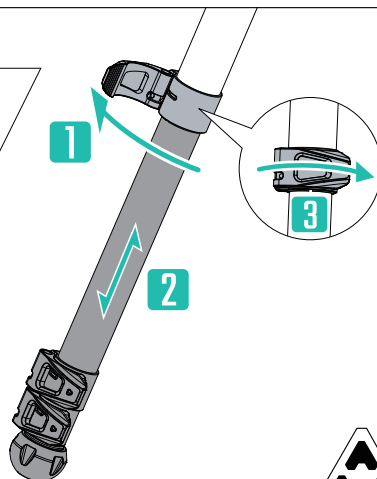
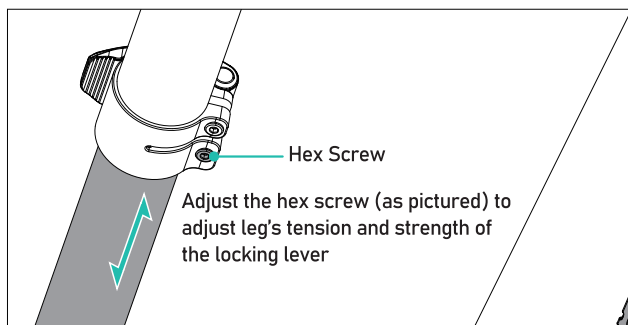

Open the locking lever **1**, adjust the length of the leg by extending or retracting it **2**, then lock the locking lever **3**.



- 1 Loosen the knob,
- 2 hold down the safety pin button,
- 3 remove the quick-release plate.

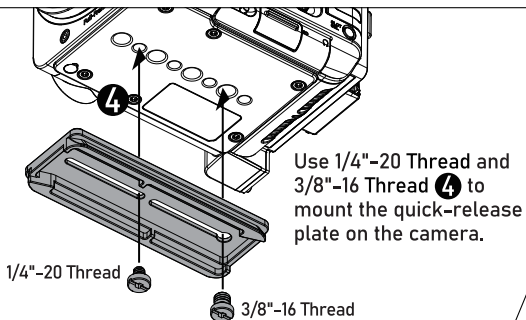
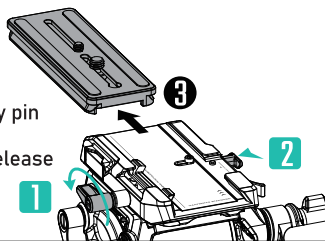

Use 1/4"-20 Thread and 3/8"-16 Thread 4 to mount the quick-release plate on the camera.

1/4"-20 Thread

3/8"-16 Thread

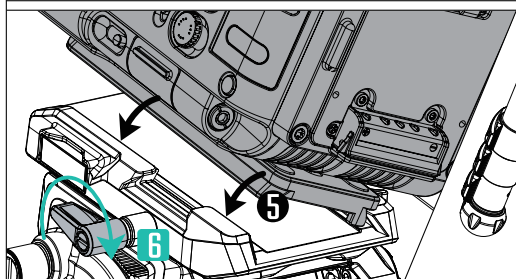

Press the camera 5 with a quick-release plate into the receiver, and tighten the knob 6 to complete the assembly.

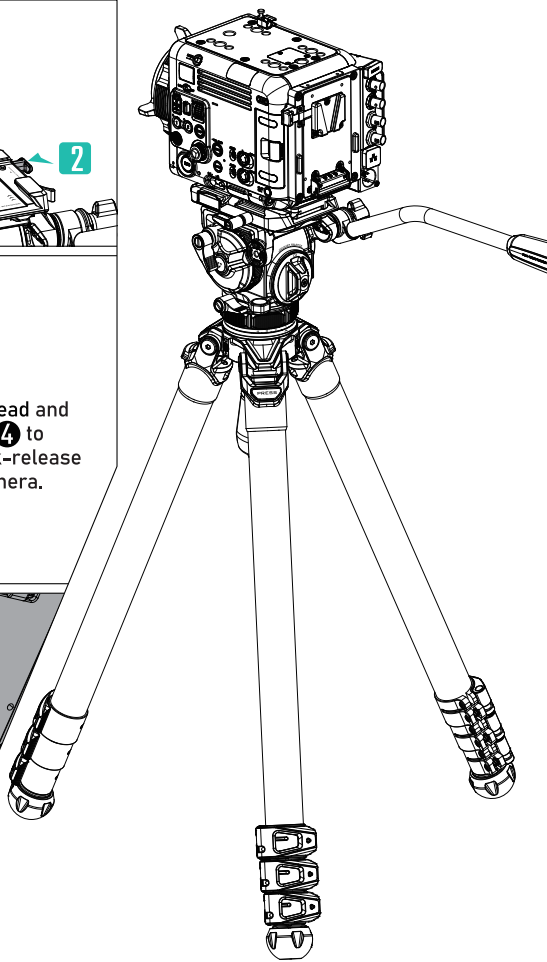

## CAUTION & WARNINGS

1. Please avoid overloading the device.
2. Do not operate in temperatures below  $-50^{\circ}\text{C}$  or above  $60^{\circ}\text{C}$ .
3. After use in humid, muddy, or dusty environments, make sure to clean the tripod with a dry cloth. If the tripod gets wet from rain, leave it extended for a few days to let any moisture within the legs dry before folding it back up.
4. Avoid prolonged exposure of the product to sunlight and prevent it from being left inside a hot car for extended hours, which can lead to overheating.
5. Never leave the product unattended when in public places. Exercise caution when operating in potentially dangerous locations.
6. It is strongly recommended not to carry the tripod when it is loaded with equipment (such as a camera).
7. The product does not require lubricants. However, if needed, please use standard lubricating oil or grease.
8. For personal safety, avoid contact with electrified objects, high-voltage equipment, or strong chemical products when using this product.





感谢您购买TILTA产品。

使用本产品之前,请仔细阅读本文以确保已对产品进行正确的设置。本文档及本产品所有相关的文档最终解释权归TILTA所有。如有更新,请访问[www.tilta.com](http://www.tilta.com)官方网站获取最新的产品信息。TILTA保留随时修改本手册中任何信息的权利,无需提前通知且不承担任何责任。

一旦使用本产品,即视为您已经仔细阅读免责声明与警告,理解、认可和接受本声明全部条款和内容。您承诺对使用本产品以及可能带来的后果负全部责任。您承诺仅出于正当目的使用本产品,并且同意本条款以及TILTA制定的任何相关条例、政策和指引。TILTA对于直接或间接使用本产品而造成的损坏、伤害以及任何法律责任不予负责。用户应遵循包括但不限于本文提及的所有安全指引。

即使存在上述规定,消费者权益依然受当地法律法规所保障,并不受本免责声明影响。

TILTA是深圳市铁头科技有限公司及其关联公司的商标。本文出现的产品名称、品牌等均为其所属公司的商标或注册商标。

## 规格参数

### ►【CT08 摄像脚架套装】

材质: 铝合金+碳纤维

重量: 4.5 KG

脚架收纳尺寸: 158 × 135.5 × 749.5 mm

脚架最小高度: 250 mm; 最大高度: 1800 mm

工作温度: -50°C ~ 60°C

### ►【CT08 液压云台】

材质: 铝合金

云台自重: 2.128 KG

云台承重: 8 KG

云台尺寸: 141 × 122 × 172 mm

动态平衡: 8档(1 ~ 8档)

阻尼档位: 俯仰阻尼4档(1 ~ 4档); 水平阻尼4档(1 ~ 4档)

俯仰角度: -60° ~ +90°

### ►【CT08 碳纤维三脚架】

材质: 铝合金+碳纤维

脚架自重: 2.3 KG

脚架承重: 22.5°(一档)时承重75 KG; 85°(四档)时承重12 KG

单脚架收纳尺寸: 136 × 127 × 599 mm

单脚架最小高度: 92 mm; 最大高度: 1681 mm

碗口直径: 75 mm 碗口

脚管直径: 36 mm / 32 mm / 28 mm / 24mm

脚管角度: 22.5°(一档) / 43°(二档) / 63°(三档) / 85°(四档)

脚架特殊配置: 高强度碳纤维单管, 扳扣式锁紧。

### ►【快装板】

快装板类型: 适合阿卡/曼富图快装板

### ►【快装板夹座】

阿卡/曼富图双规格夹座(可前后调节重心, 夹座可拆下更换为铁头8寸燕尾滑板。)



## 【曼富图快装板】

- 防滑胶垫 1  
1/4螺丝 2  
3/8螺丝 3

## 【液压云台】

## 4 阿卡/曼富图双规格调平夹座

- a. 阿卡/曼富图双规格快装  
b. 前后移动摄像机调节重心平衡

## 5 水平仪

## 6 快装板锁紧旋钮

## 7 俯仰锁紧旋钮

- 开启/锁紧俯仰方向运动

## 8 牙盘接口(安装手柄)

## 9 4档俯仰阻尼调节手轮

- a. 调节俯仰阻尼力的大小  
b. 4档(1-4档)俯仰阻尼调节

## 10 水平锁紧旋钮

- 开启/锁紧水平方向运动

## 11 水平仪

## 12 球头

## 快装板防掉按钮 13

## 调平夹座锁紧扳扣 14

## 手柄锁紧旋钮 15

## 手柄 16

## 8 档动态平衡调节手轮 17

- a. 根据摄像机的重力调节回弹力  
b. 8档(1-8档)动态平衡调节

## 4 档水平阻尼调节手轮 18

- a. 调节水平阻尼力的大小  
b. 4档(1-4档)水平阻尼调节

## 云台锁紧螺丝 19

## 【碳纤维三脚架】

## 20 75 mm 碗口球座

## 21 脚架角度调节按键

- 4档支撑角度调节

## 22 碳纤维脚管

## 1/4定位螺纹孔 27

## 云台锁紧短手柄 29

## 23 脚管夹座

24 伸缩脚管  
锁紧扳扣

## 25 旋转式脚垫

## 26 隐藏式脚钉

## 挂钩 28

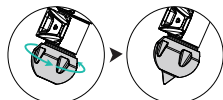

(右旋脚垫切换为脚钉模式)

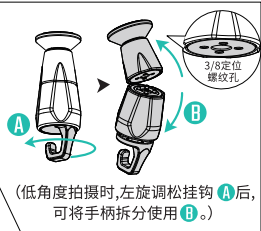

## 10 液压云台—功能介绍(一)

### 俯仰阻尼调节

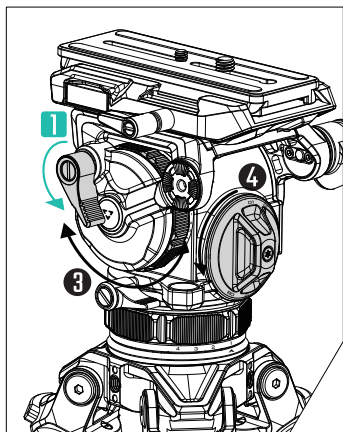

松开**1**俯仰锁紧旋钮,云台开启  
**+90°**至**-60°**的俯仰方向运动**2**。

#### 阻尼调节

转动**3**俯仰阻尼调节手轮,可  
**4**档(1-4档)调节俯仰阻尼力  
的大小。

#### 动态平衡调节

转动**4**动态平衡调节手轮,  
可**8**档(1-8档)调节回弹力。

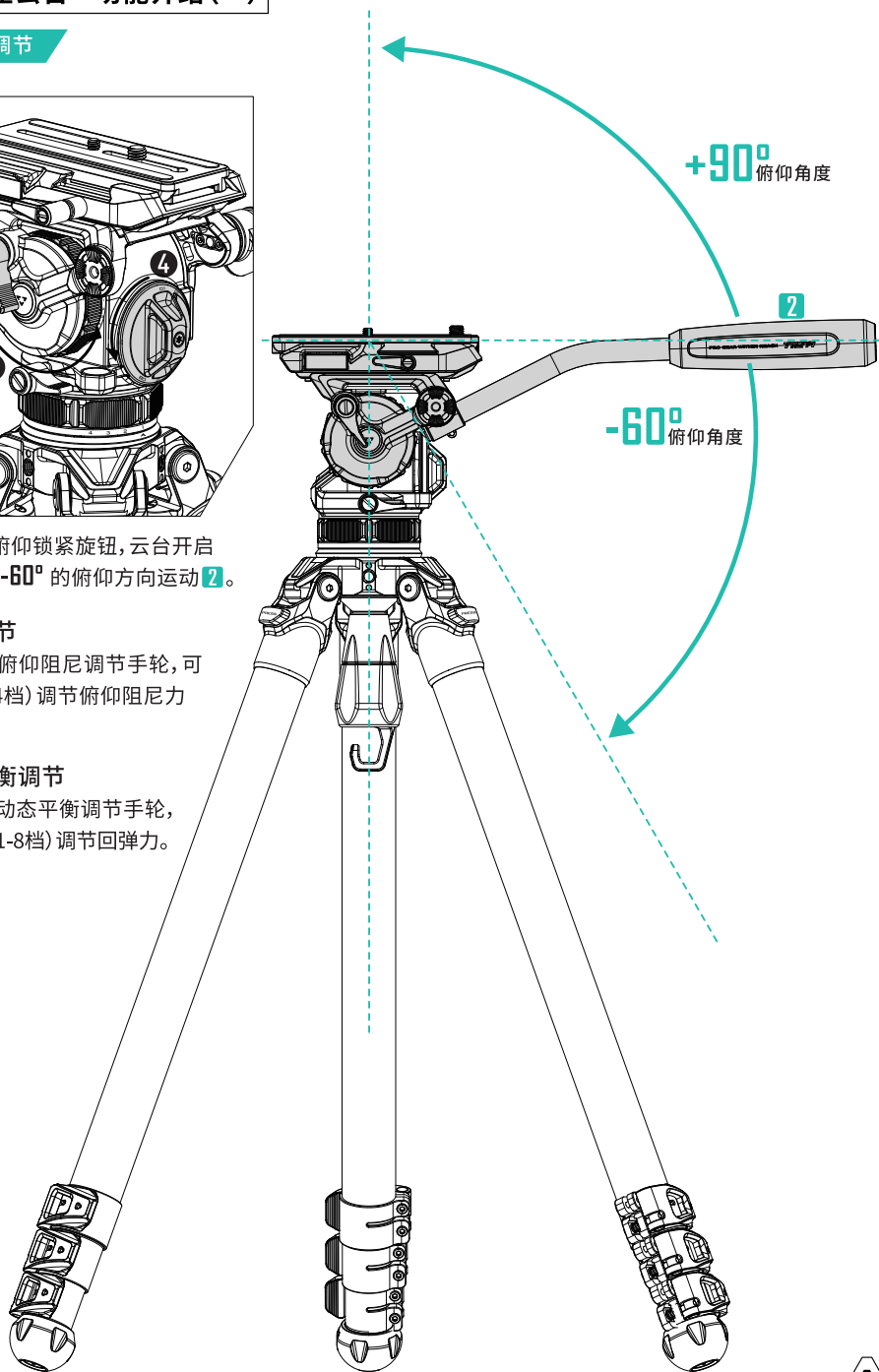

# 11 液压云台—功能介绍(二)

## 水平阻尼调节

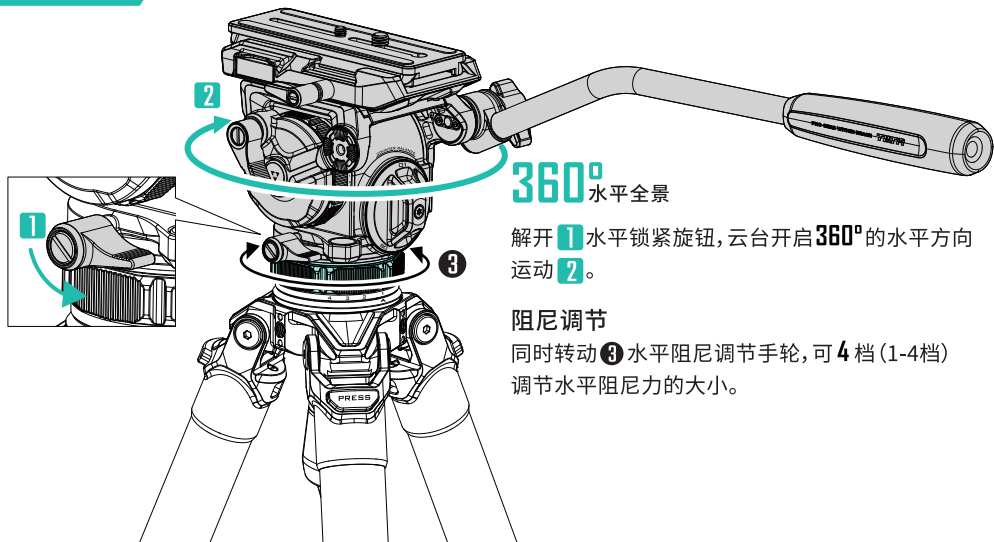

**360°** 水平全景

解开 **1** 水平锁紧旋钮, 云台开启 **360°** 的水平方向运动 **2**。

阻尼调节

同时转动 **4** 水平阻尼调节手轮, 可 **4** 档 (1-4档) 调节水平阻尼力的大小。

## 前后重心调节



阿卡/曼富图双规格调平夹座

调节 **1** 锁紧扳扣, 可前后移动夹座 **2** 调节摄像机重心平衡。

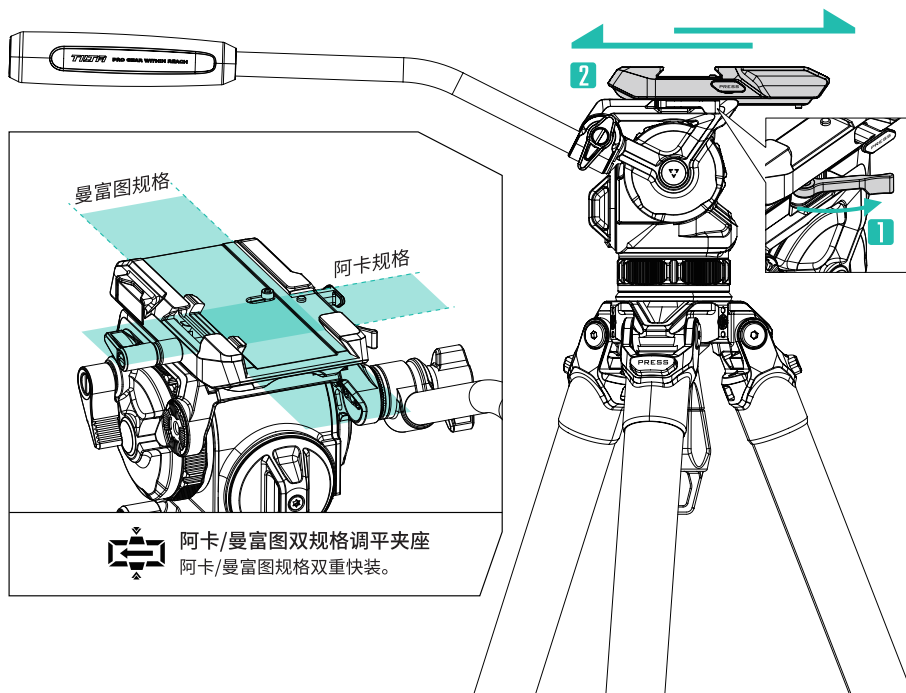

阿卡/曼富图双规格调平夹座  
阿卡/曼富图规格双重快装。



## 12 液压云台—功能介绍(三)

### 调平夹座可更换为铁头 燕尾滑板(选配)

调整夹座位置, 松开 **1** 扳扣并取下夹座底下的 **2** 内六角螺丝, 取出 **3** 夹座。

更换为 **4** 铁头 摄像脚架专用8寸ARRI规格燕尾滑板(TT-ADA-8-SG)或铁头 摄像脚架专用8寸15mm燕尾滑板(TA-TAP8-SG)滑入在云台上, 锁紧扳扣 **5** 即可。

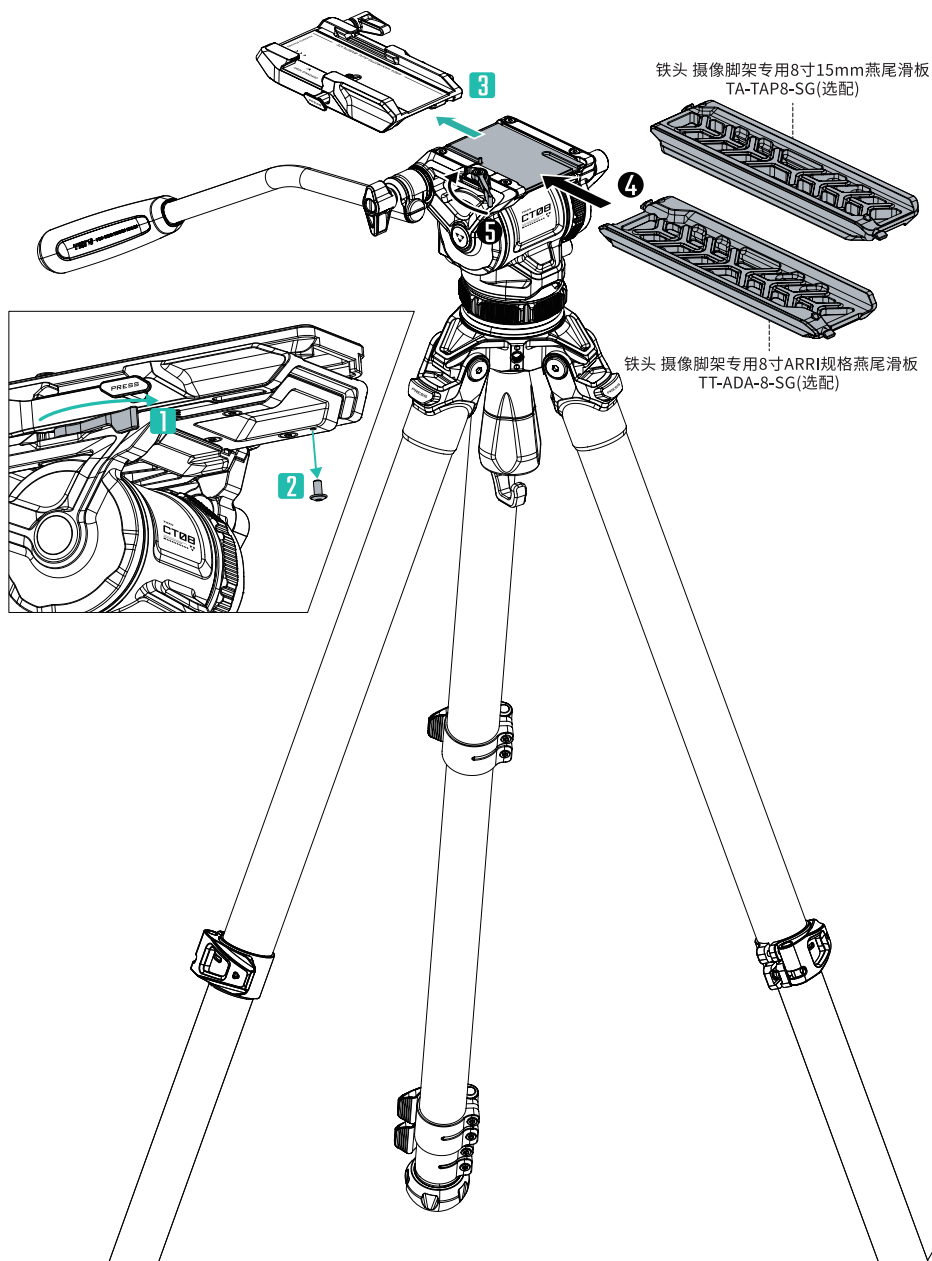

# 13 三脚架—功能介绍

## 四档脚管角度调节

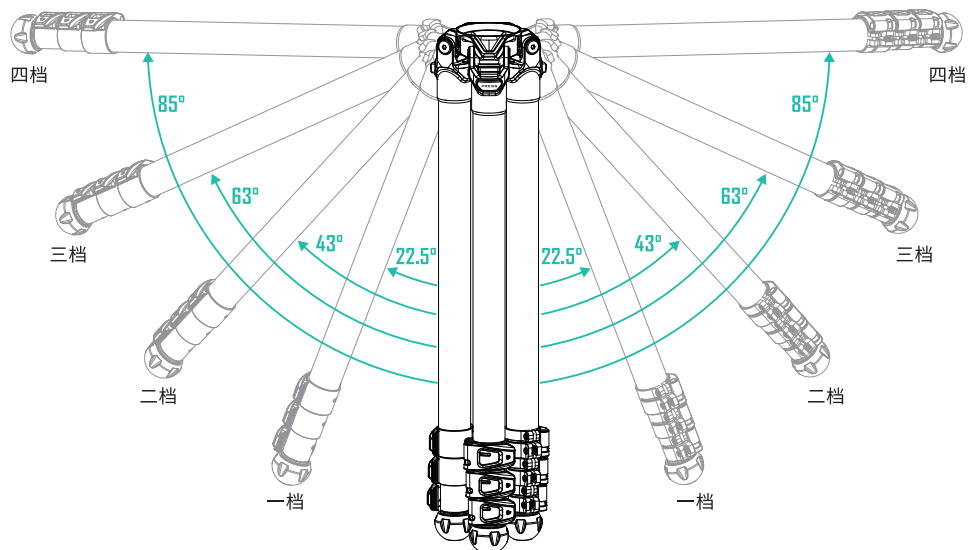

◀ 收拢状态下,可直接抬起脚管成一档的角度调节 ▶

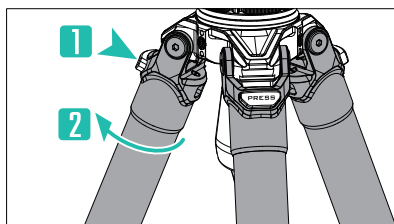

在三角架非支撑状态下,按住 **1** 角度调节按键不放的同时 **2** 抬起脚管完成二档、三档或四档的角度调节。

## 脚管伸缩调节

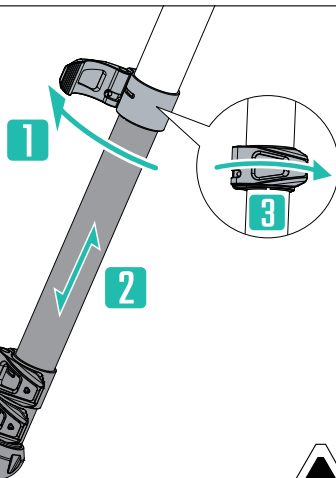
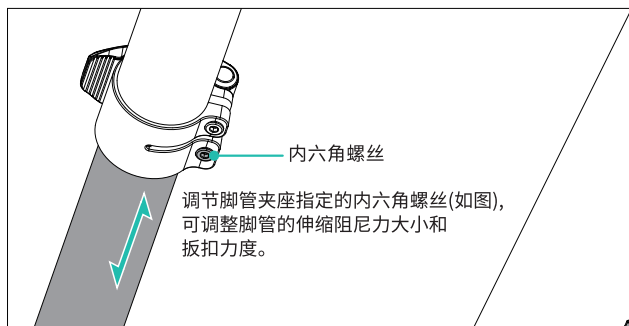

打开 **1** 扳扣,上下伸缩 **2** 调节脚管长度,再锁紧扳扣 **3** 即可。



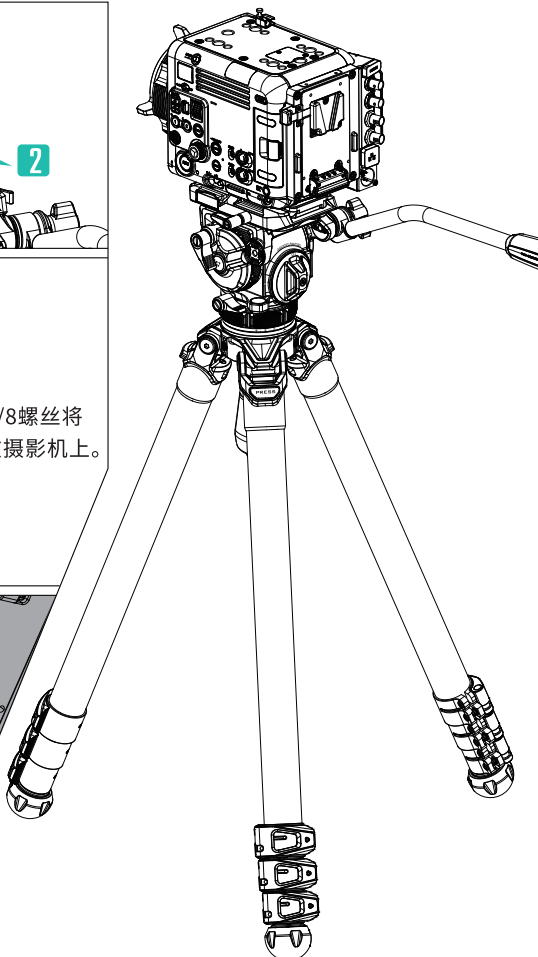
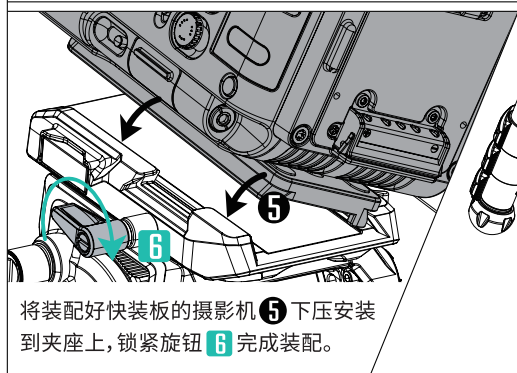
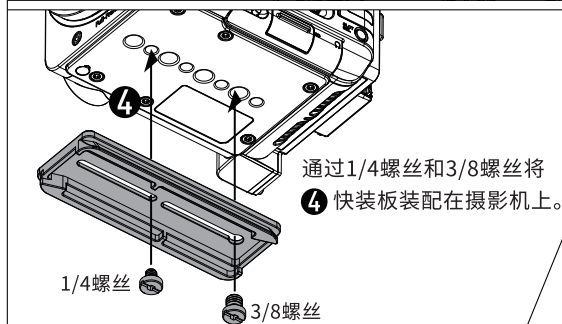
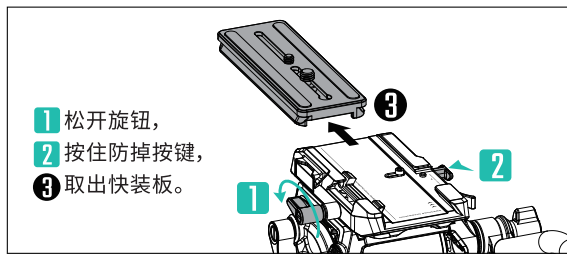

## 注意事项

1. 请勿超负荷使用。
2. 请勿在低于零下50°C及高于60°C的温度下操作。
3. 当处于潮湿、泥沙、风尘环境时，使用完毕后一定要将三脚架用干布擦干净；被雨水淋湿的时候也一样，伸出状态放置几天等脚管内部的水分干燥后再收拢。
4. 请勿将产品在阳光下长时间放置，避免产品靠在汽车玻璃旁经历高温长达数小时。
5. 在公共场所使用本产品时，请勿离人；在危险的地方使用时，请慎重操作。
6. 禁止脚架搭载设备（相机）一起携带移动。
7. 产品无需配备润滑剂，如在某些情况下必需使用时，请使用标准润滑油或油脂。
8. 为了人身安全，在使用产品时请勿与带电物品以及高压设备或强效化学用品接触。



**TILTA 75MM CINE FLUID HEAD WITH 3-STAGE  
CARBON FIBER LEGS (8KG)**