

TILTA

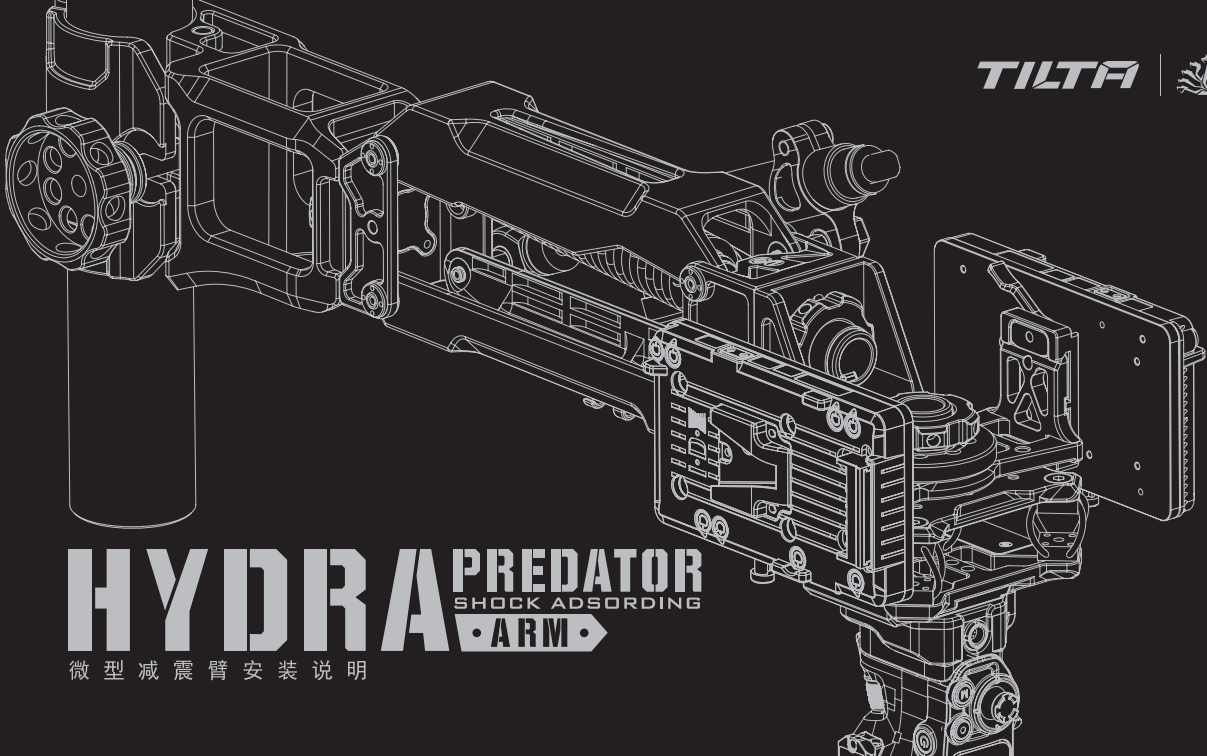

HYDRA PREDATOR

SHOCK ADSORING

ARM

微型减震臂安装说明

01

免责声明和警告

感谢您购买 TILTA 产品。本文所提及的内容关系到您的安全以及合法权益与责任。

使用本产品之前, 请仔细阅读本文以确保已对产品进行正确的设置。不遵循和不按照本文的说明与警告来操作可能会给您和周围的人带来伤害, 损坏本产品或其它周围的物品。本文档及本产品所有相关的文档最终解释权归 TILTA 所有。如有更新, 恕不另行通知。请访问 www.tilta.com 官方网站以获取最新的产品信息。

一旦使用本产品, 即视为您已经仔细阅读免责声明与警告, 理解、认可和接受本声明全部条款和内容。您承诺对使用本产品以及可能带来的后果负全部责任。您承诺仅出于正当目的使用本产品, 并且同意本条款以及 TILTA 制定的任何相关条例、政策和指引。

TILTA 对于直接或间接使用本产品而造成的损坏、伤害以及任何法律责任不予负责。用户应遵循包括但不限于本文提及的所有安全指引。

即使存在上述规定, 消费者权益依然受当地法律法规所保障, 并不受本免责声明影响。

TILTA 是深圳市铁头科技有限公司及其关联公司的商标。本文出现的产品名称、品牌等, 均为其所属公司的商标或注册商标。

02

IN THE BOX | 物品清单

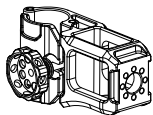

Hydra Alien Rail
Mounting Attachment

2英寸管夹转接件
× 1

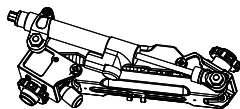

Hydra Predator Shock
Absorbing Arm

减震臂
× 1



Hydra Alien Shock
Absorbing Head

钢丝减震头
× 1

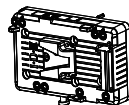

V-mount Battery Plate

V口供电板
× 2

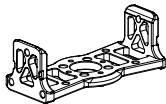

Hydra Alien Dual Battery
Plate Support Bracket

供电U型支架
× 1

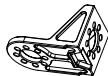

Hydra Alien 90 Degree Adapter
for Shock Absorbing Head

减震头接驳件
× 1



Power Supply Base
Plate for RS 2

RS 2专用供电底座
× 1



Quick Release Plate

(Manfrotto 500/577/ 701)
快装板
(通用曼富图500 577 701)
× 1

03 IN THE BOX | 物品清单

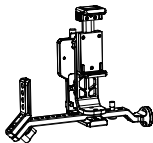

Hydra Alien
Monitor Bracket

监看支架
× 1

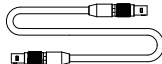

6-Pin Lemo to 6-Pin Lemo
Cable (500 cm)

5m 控制线
(0B-6芯45度直头)
× 1



Remote Control Handle
for RS 2/Ronin S

如影系列控制手柄
× 1



Wireless Control Receiver
Module for RS 2

控制接收盒
× 1



Hydra Alien Cable Clamp
Suction Cup

线卡 (小吸盘)
× 10



220g counterweight

220g配重砝码
× 8

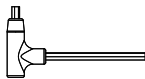

T Handle Hex Key

T型4M M 球头六角螺丝刀
× 1

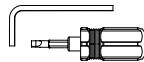

Hex Key & Flat
Head Screwdriver

螺丝刀扳手

04

安装2英寸管夹转接件

将2英寸管夹转接件旋钮松开，打开管夹扣板，将管夹安装至钢管上方，锁紧旋钮完成安装。

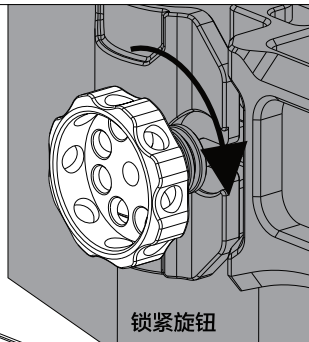
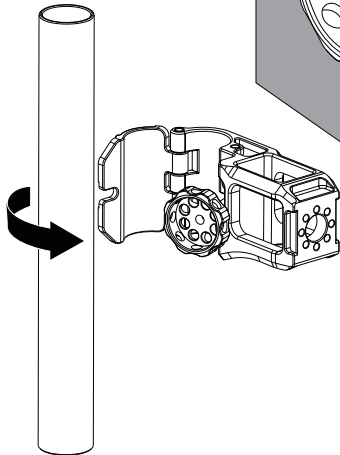
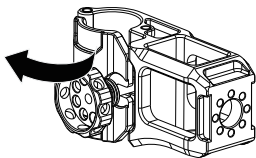
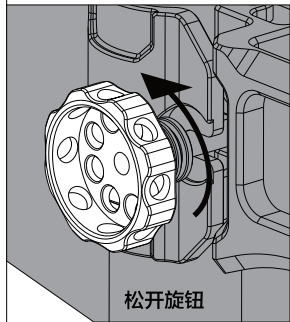

05

减震臂安装

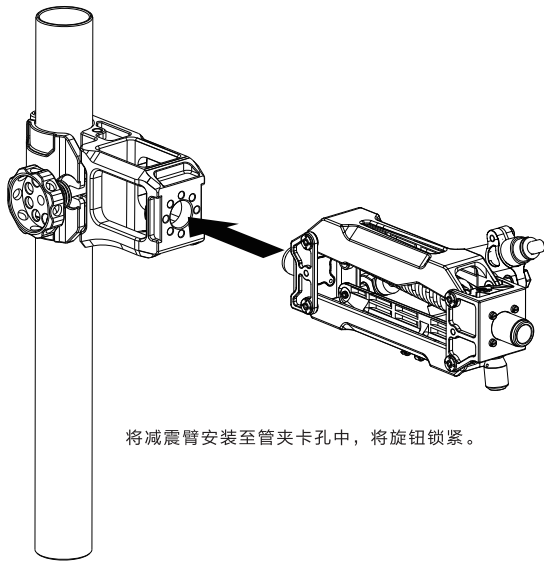

将减震臂安装至管夹卡孔中，将旋钮锁紧。

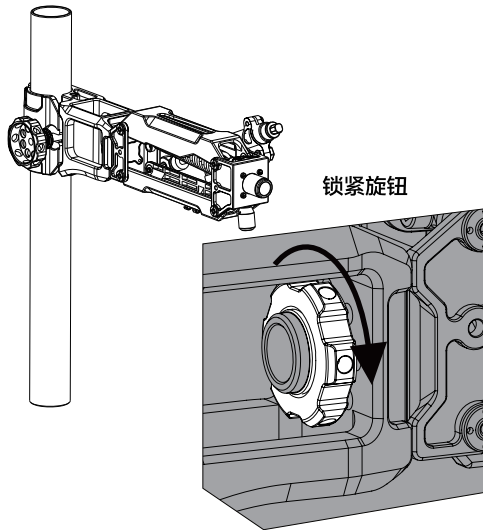

锁紧旋钮

06

供电模块安装

将V口供电安装至供电支架两侧，扳动安全锁扣，锁紧供电板完成安装。

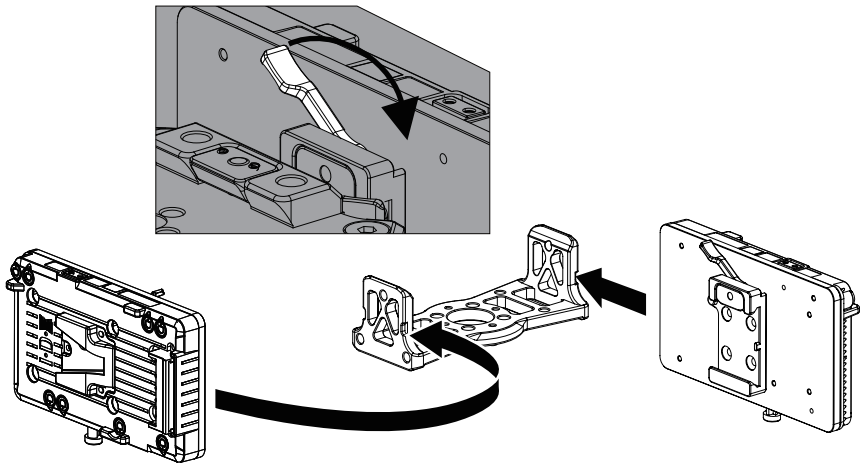

07

减震U型供电板安装

将供电模块安装至钢丝减震头上方，再安装减震头接驳件，锁紧旋钮完成安装。

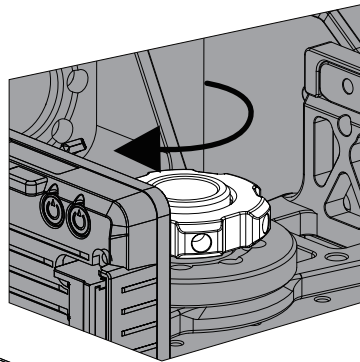
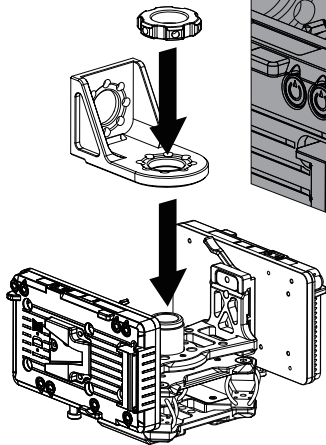
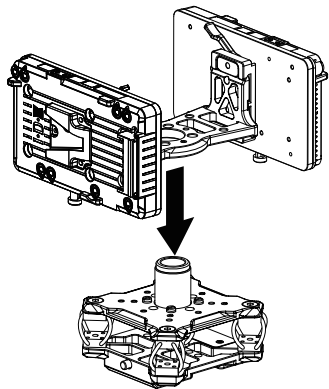

08

减震头模块安装

将减震U型供电板安装至减震臂上，锁紧旋钮完成安装。

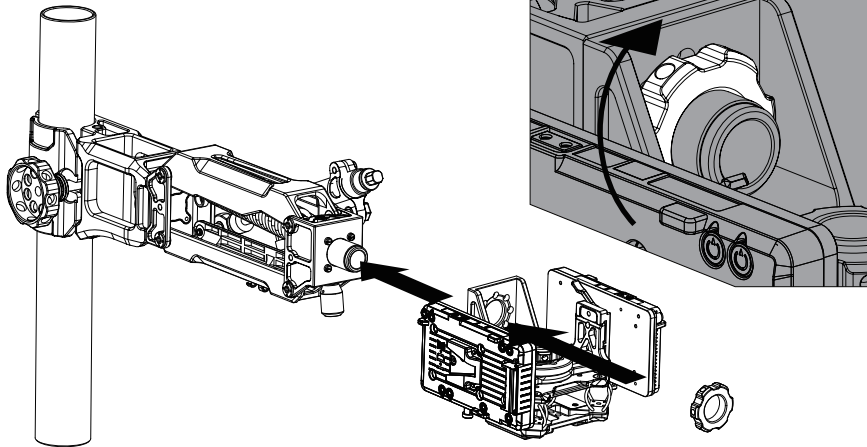

09

RS2 供电安装

将快装板安装至供电底座底部上。
拆下RS 2供电底座上的加强杆。

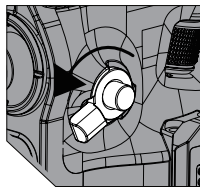
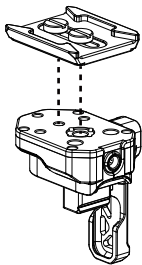

插入后拧紧云台手扭

1. 将①RS 2供电底座插入RS 2云台中，稳固搭载RS 2云台。
2. 将②加强杆往上套在稳定器的NATO部件上锁紧在RS 2供电底座上。
3. 将③螺丝锁紧在RS 2供电底座上。

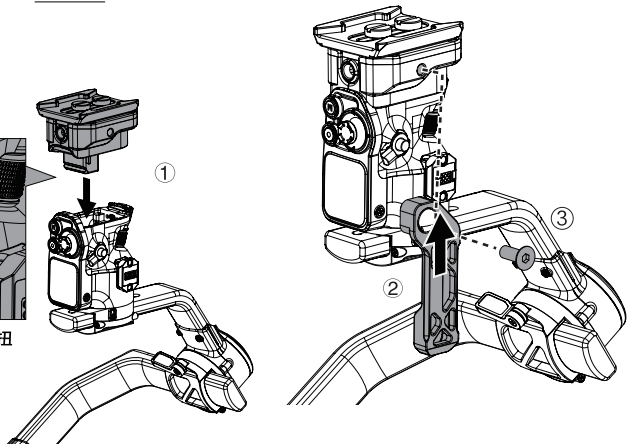

10

安装控制接收盒

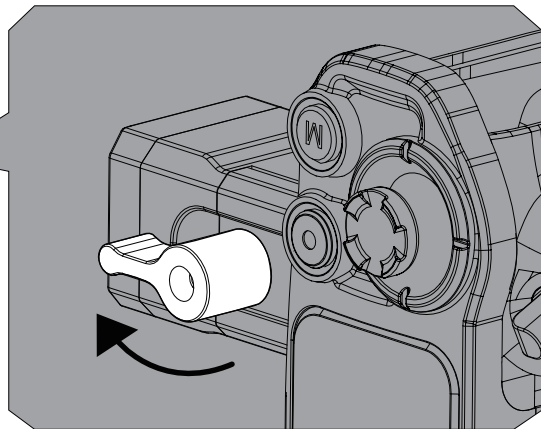
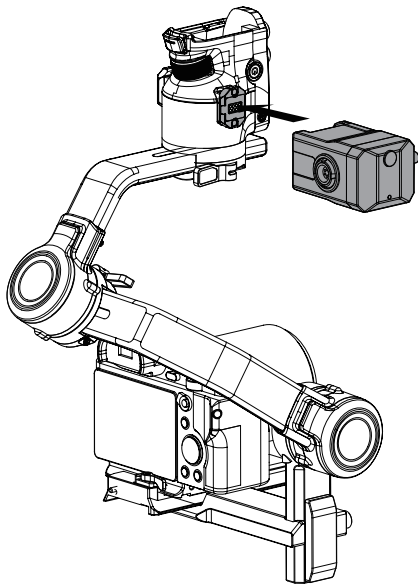

将控制接收盒安装至DJI RS2右边的NATO接口上并拧紧手扭螺丝，此时显示灯为绿色。(安装时需根据说明书来使用，以免对触针造成损坏)

11

RS2安装

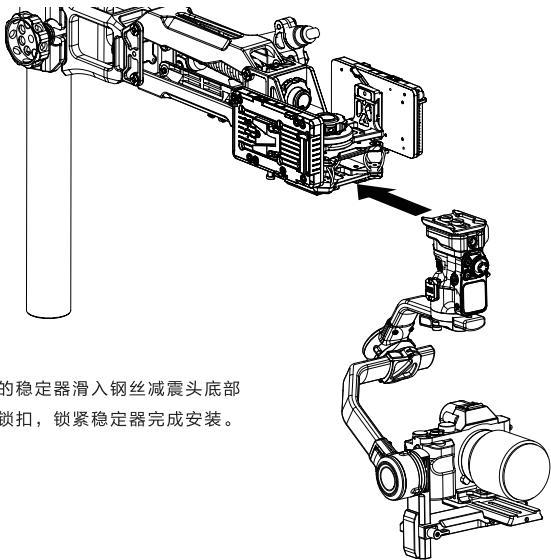

将安装好的稳定器滑入钢丝减震头底部
扳动安全锁扣，锁紧稳定器完成安装。

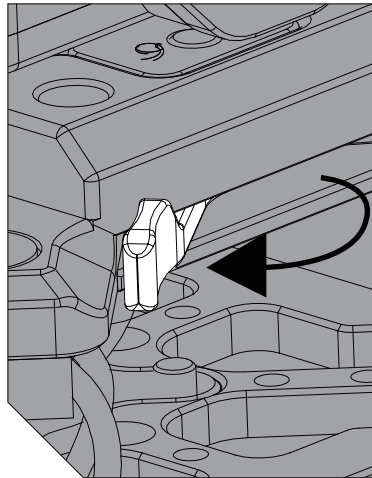

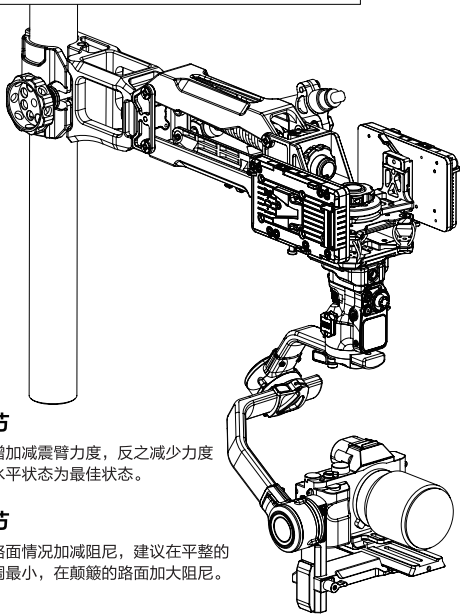

力度调节

顺时针旋转增加减震臂力度，反之减少力度
调节到力臂水平状态为最佳状态。

阻尼调节

根据不同的路面情况加减阻尼，建议在平整的
路面上阻尼调最小，在颠簸的路面加大阻尼。

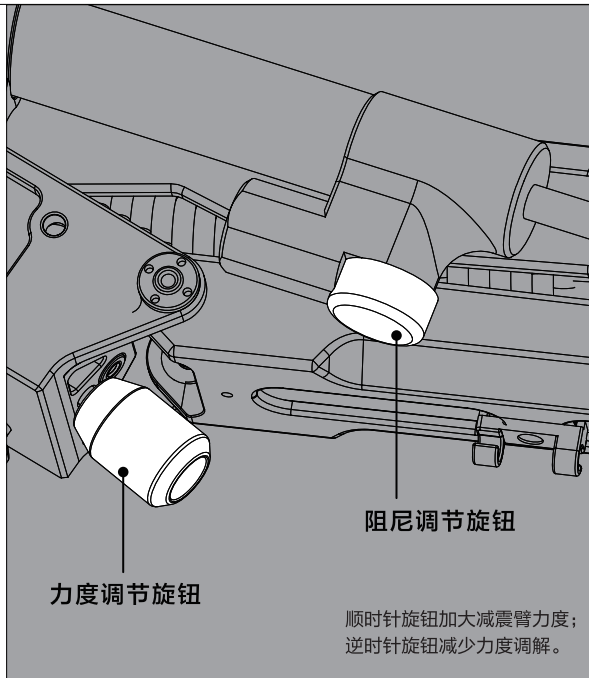

力度调节旋钮

阻尼调节旋钮

顺时针旋钮加大减震臂力度；
逆时针旋钮减少力度调解。

13

功能-支撑架

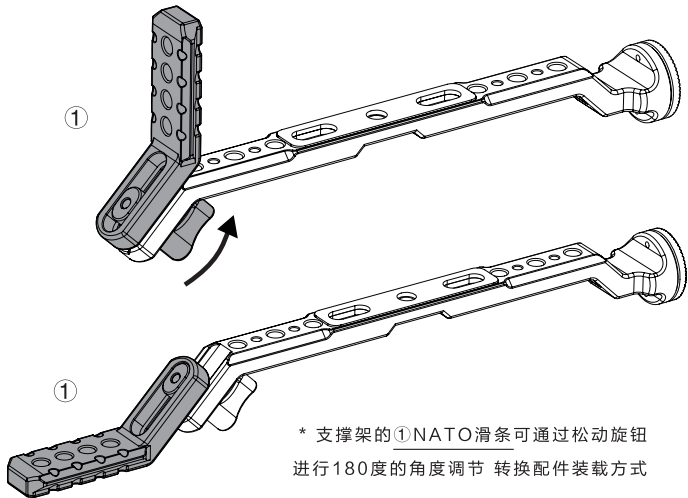

* 支撑架的①NATO滑条可通过松动旋钮进行180度的角度调节 转换配件装载方式

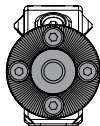

ARRI牙盘
[右面]

可外接TILTA
如影系列控制
手柄等

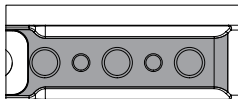

1/4定位孔 [顶面]

可外接其他配件

NATO滑条*
[左面]

可外接原力N
跟焦手轮等

1/4定位孔
[左面]

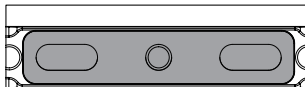
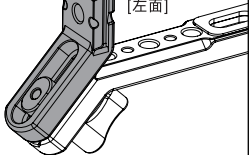

1/4螺丝孔 [顶面中间]

可接监视器/手机支架等

防滑保护胶垫 [顶面] 协助稳固设备 避免刮蹭

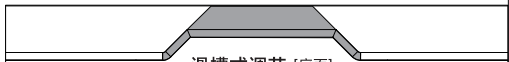

滑槽式调节 [底面]

滑槽式灵活调节前后位置 便于后方挂载图传设备

14

装配—伸缩V口扣板

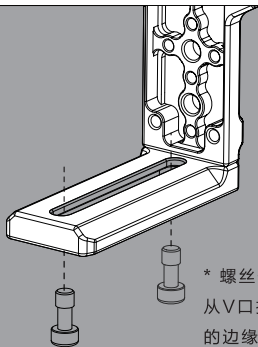

* 螺丝仅能
从V口扣板底部
的边缘两端安装

1. 伸缩V口扣板通过1/4螺丝安装在支撑架上的1/4螺丝孔上，可便于拓展监视器、V口电池。

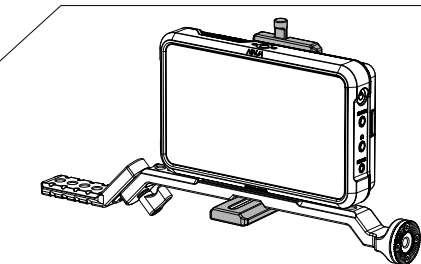
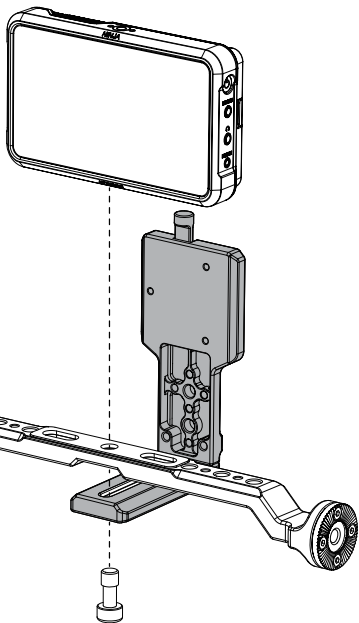

2. 监视器(选配)装配组合图(监视器最大限7寸以内)

3. 伸缩V口扣板背面可挂载V口电池，给图传或监视器供电。

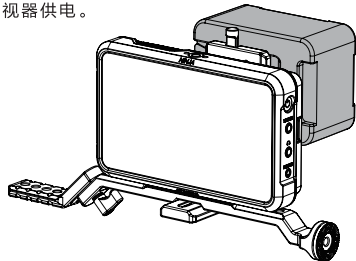

15

装配-手机支架

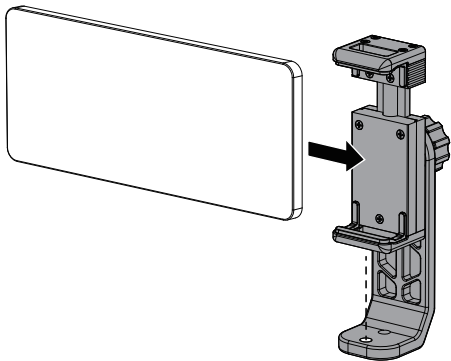

1. 标配手机支架 可安装至中间1/4螺丝孔上
装载手机进行实时监控 轻巧简洁

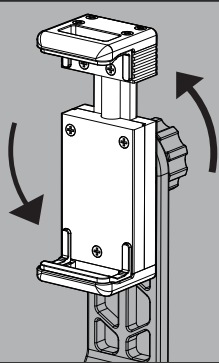
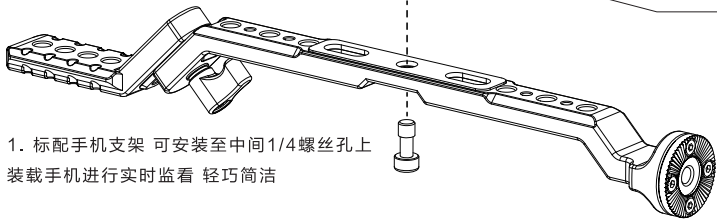

2. 手机支架卡扣可360度旋转，
调整合适角度。

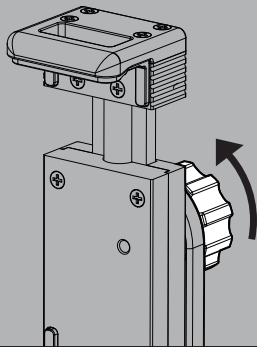

3. 调整好角度后，拧紧旋钮锁紧
卡扣。

16

控制手柄搭配监看支架

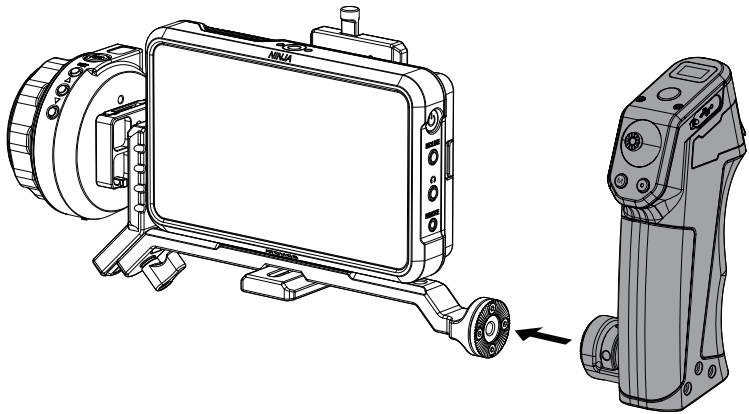

监看支架——为车载设备控制RS 2云台设计

1. 将控制手柄通过牙盘转接件安装到监看支架上，再拧紧完成装配。
可实现远程控制和实时监看。

[拓展使用]

2. 监看支架可搭配原力N手轮进行跟焦

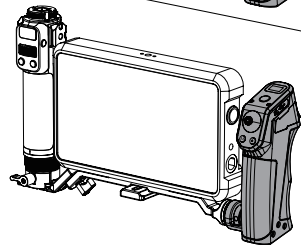
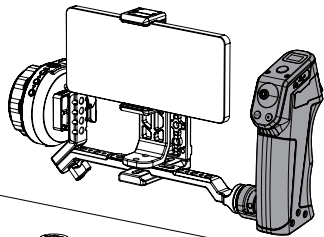

3. 搭配双跟焦手柄来进行跟焦/变焦

17 拓展18650供电盒(选配)

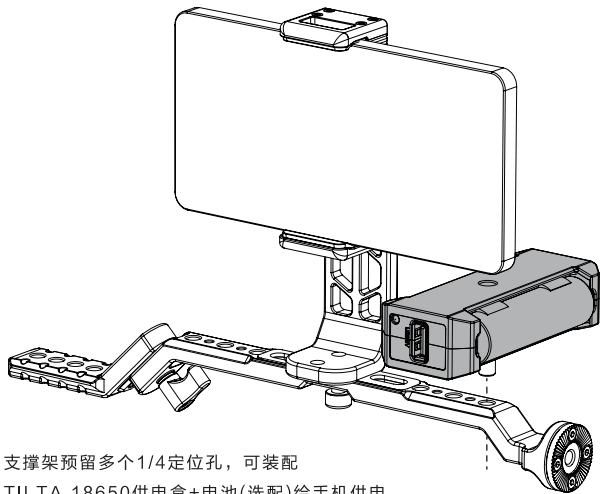
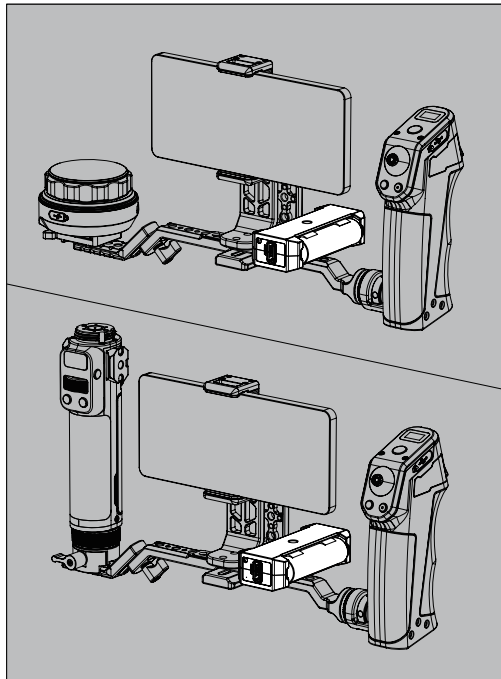

支撑架预留多个1/4定位孔，可装配
TILTA 18650供电盒+电池(选配)给手机供电。

* 18650供电盒是稳定type-c 5V、DC OUT 8V常规输出接口。
外接设备请按照设备额定电压操作,以免对机器造成损伤。

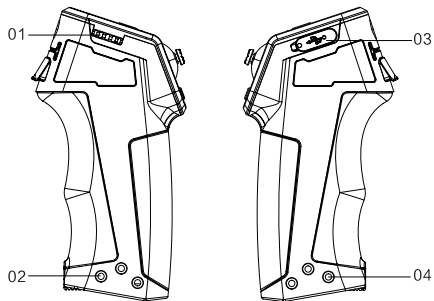

侧面

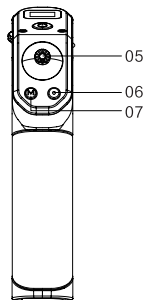

正面

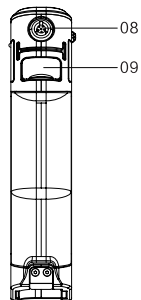

背面

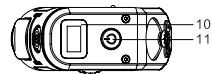

顶面

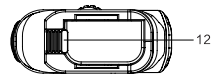

底面

01 侧边拨盘
02 左边扩展孔
03 Type-C口

04 右边扩展孔
05 摇杆
06 相机控制按键

07 模式M按键
08 LEMO输出
09 扳机Trigger键

10 显示屏
11 开关机键
12 电池卡扣

19

功能-控制手柄

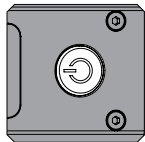

电源按键

长按 3 秒：开、关机
单击：切换主界面
双击：云台休眠
再双击：唤醒云台
三击：进入菜单功能设置

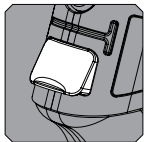

扳机Trigger键

单击：开始智能跟随
(安装图传系统并开启)
双击：云台回中
三击：进入自拍模式
长按不放：进入锁定模式

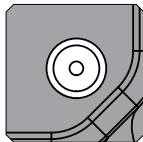

相机控制按键

半按：控制自动对焦
短按：开始或停止录像
长按：拍照

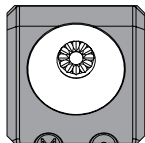

摇杆

上下摇动：控制俯仰轴运动
(默认)
左右摇动：控制平移轴运动
(默认)

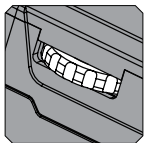

侧边拨盘

往顺时针方向为调节云台
速度加快,逆时针方向为调
节云台速度减慢

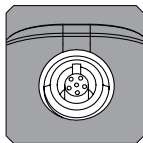

LEMO输出

0B-6芯LEMO线控输出
可通过转接线接到控制盒
来操控云台各种功能

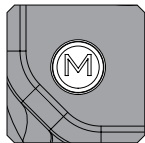

M 按键

单击：切换云台模式
双击：竖拍模式,再次双击 M 键取消竖拍模式。
三击：进入 360 旋转模式,重复可退出。360 旋转模式下,向左或向右连续摇动摇杆两次,
可使相机自动旋转,双击扳机键可停止。
长按不放：进入运动模式。长按并双击扳机锁定运动模式,(不需保持长按不放)重复操作可退出。

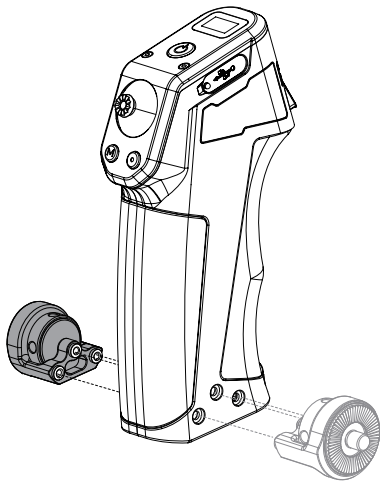

* 控制手柄标配1个牙盘转接件，可根据需求自由切换。

1. 安装①牙盘转接件

安装于手柄侧面的
扩展孔上，可拓展
手柄其他功能。

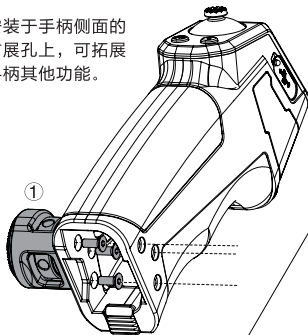

2. 安装③电池(产品中不含F550/F570电池)

插入③F550/F570电池，即可开机操作。
(使用手柄时需搭配控制接收盒)

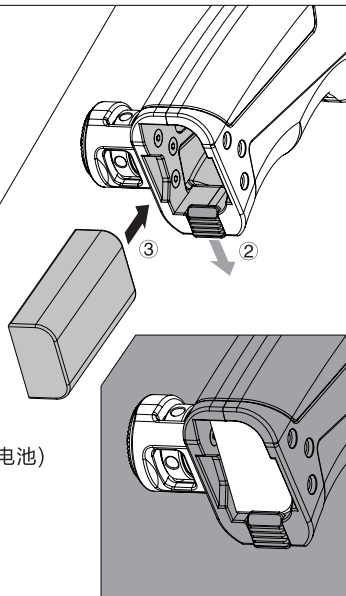

21

控制手柄对频方式 实现无线远程操控

同时按住M键和录制键可快速进入自动搜索状态，再双击RS2接收盒上的按键，指示为红灯闪烁,此时控制手柄搜索连接后，RS2接收盒的指示灯自动变绿灯。对频成功,控制手柄可以无线操控云台,无线距离为80M。

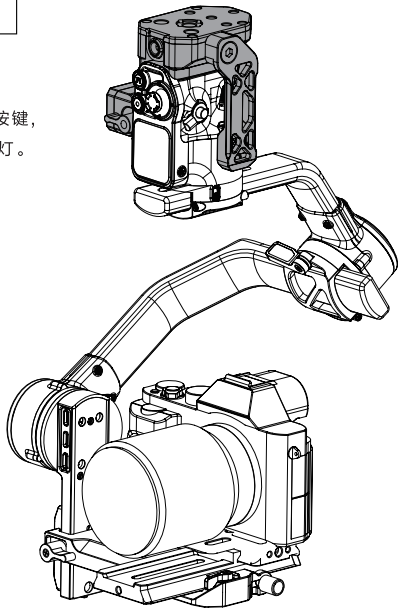
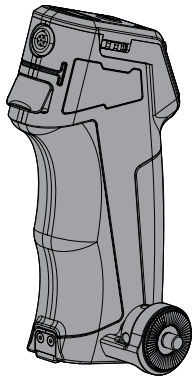

22

可连接5m(0B-6芯)控制线 实现精准控制

手柄后端预留有0B-6芯Lemo头(13-17v)电源输入口
可通过5m控制线连接到控制接收盒上，实现精准控制。

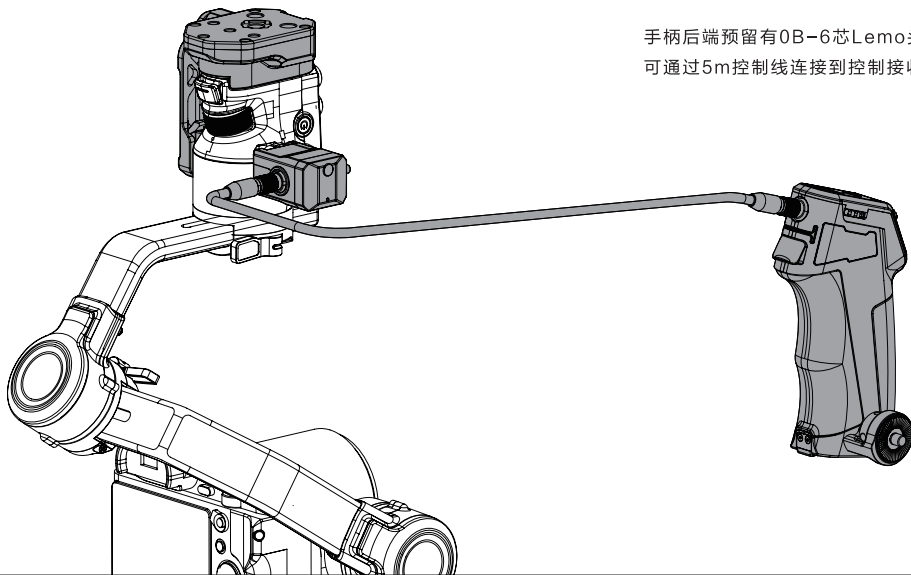

23

控制手柄菜单功能

长按开机键 进入菜单键

单击开机键 回到主菜单

双击开机键 云台休眠

进入菜单栏 (M键是确定键, 录制键是返回键, 摇杆 (上下为上下选, 左右无效, 长按3S为快速选择))

无线设置

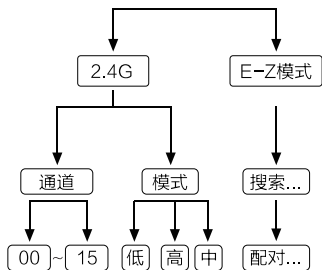

马达设置

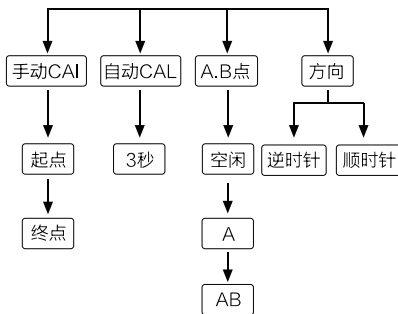

系统设置

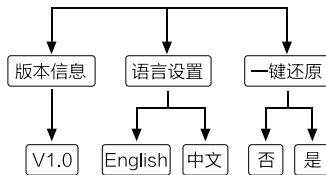

Thank you for purchasing a TILTA product. What is mentioned in this article is related to your safety, legal rights and liabilities. Before using this product, please read this article carefully to ensure a proper configuration. Failure to follow the instructions or any disregard for the warnings may cause harm to you and other people, and may cause damage to this product and surrounding objects. TILTA owns the right to final interpretation of this document and all other collateral documents. Updates on information are subject to change without prior notice. For up-to-date product information, please visit the official website, www.tilta.com.

By using this product, you hereby signify that you have read this disclaimer and warning carefully and that you understand, agree to, and accept the terms and conditions herein. You agree that you are solely responsible for your own conduct while using this product and for any consequence thereof. You agree to use this product only for proper purposes and abide by all the terms, policies and guidelines TILTA has made and may make.

TILTA accepts no liability for damage, injury or any legal responsibility incurred directly or indirectly from the use of this product. The user shall observe safe practices including, but not limited to, those set forth in this document.

Despite the terms mentioned above, consumers' rights and interests are still protected by local laws and regulations, and are not affected by this disclaimer.

TILTA is a trademark of Shenzhen TILTA Technology Co., Ltd. and its affiliated companies. Product names and brands in this document are trademarks or registered trademarks of its affiliates.

25

INSTALLING HYDRA ALIEN RAIL MOUNTING ATTACHMENT

Loosen the tie down screw on the rail mounting attachment and open the rail clamp. Install the rail clamp to the rail. Tighten the tie down to complete the installation.

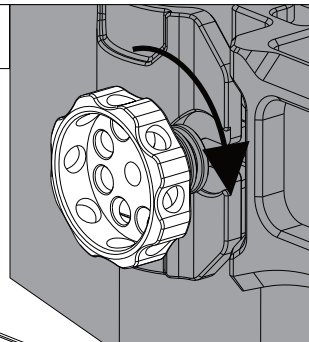
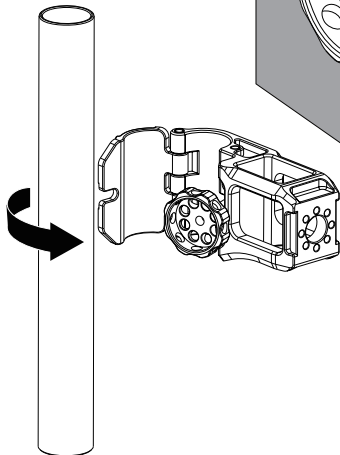
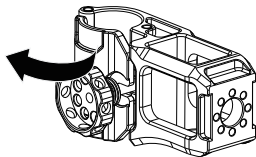
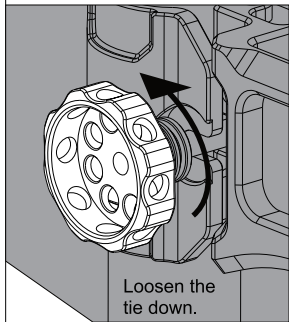

26

INSTALLING HYDRA PREDATOR SHOCK ABSORBING ARM

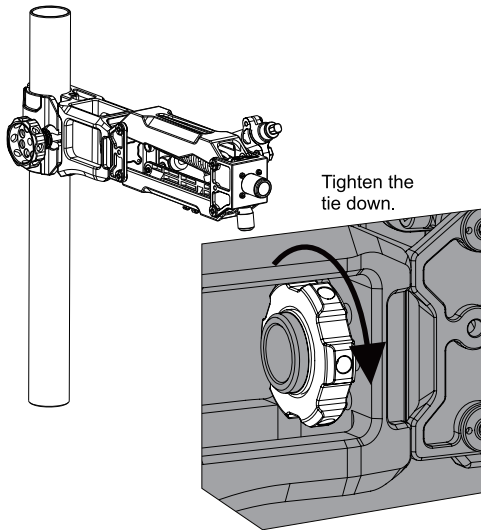
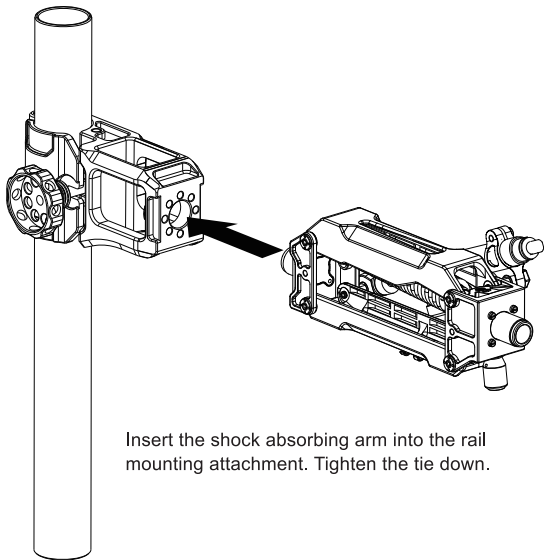

27

INSTALLING BATTERY PLATES

Mount the two V-mount battery plates onto the two sides of the dual battery plate support bracket.

Tighten the locking pin on the battery plate to complete the installation.

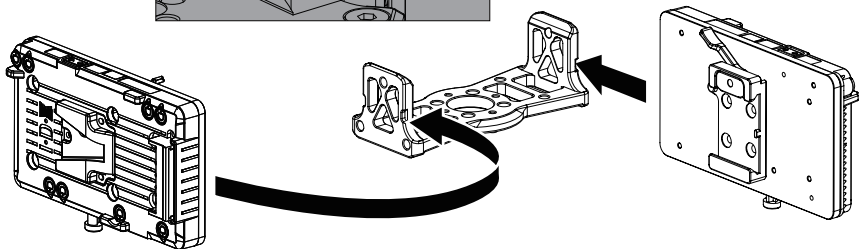
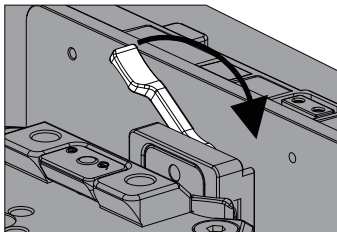

28 INSTALLING DUAL BATTERY SUPPORT BRACKET (V-MOUNT)

Mount the dual battery support bracket on top of the shock absorbing head.

Next, install the 90 degree adapter.

Tighten the tie down to complete the installation.

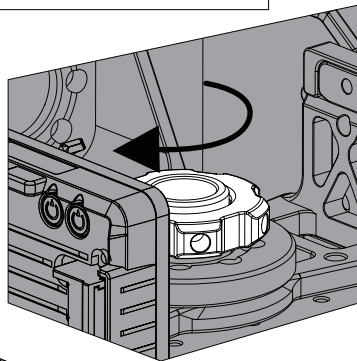
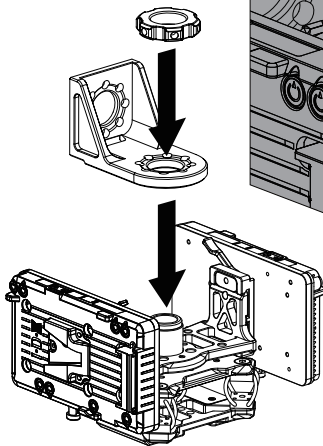
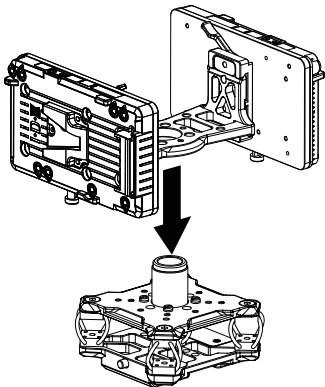

29

INSTALLING SHOCK ABSORBING HEAD

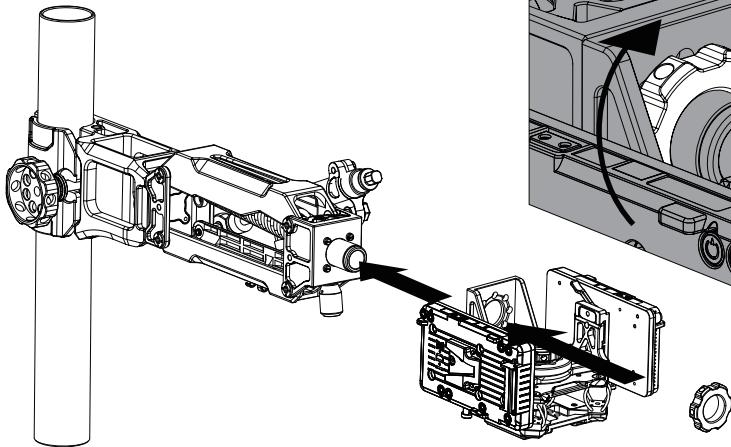

Install the dual battery support bracket (V-mount) to the shock absorbing arm.

Tighten the tie down to complete the installation.

30

INSTALLING POWER SUPPLY BASE PLATE

Install the quick release plate to the power supply base plate. Disassemble the holding bracket on the power supply base plate.

1. Insert ① power supply base plate into the RS 2 gimbal.
2. Mount the ② holding bracket over the gimbal's NATO rail.
3. Secure it ② onto the power supply base plate.

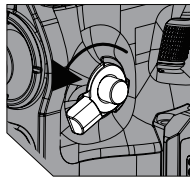
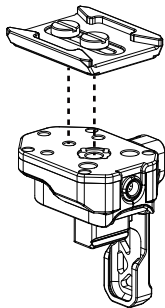

After mounting the base plate, tighten the gimbal tie down

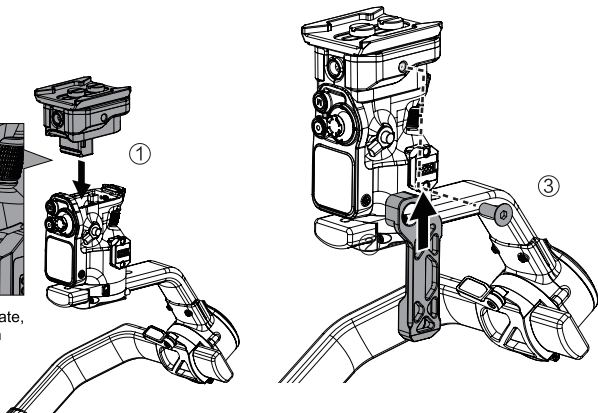

31

INSTALLING WIRELESS CONTROL RECEIVER MODULE

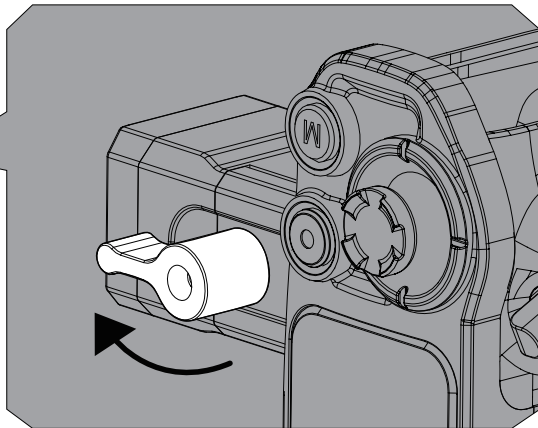
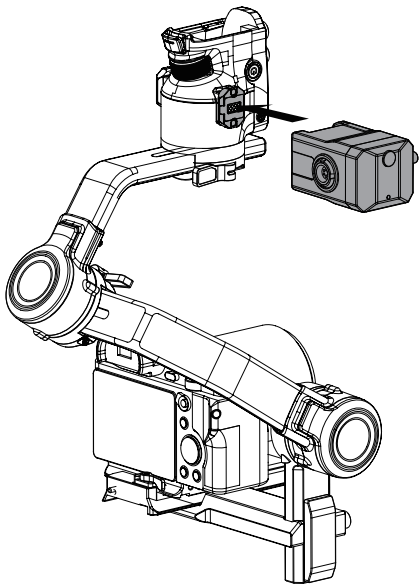

Attach the remote control receiver module to the NATO rail on the right side of DJI RS 2. Tighten the tie down. The indicator light will blink green.

(Please follow the instructions for the installation to avoid damage to the contact points.)

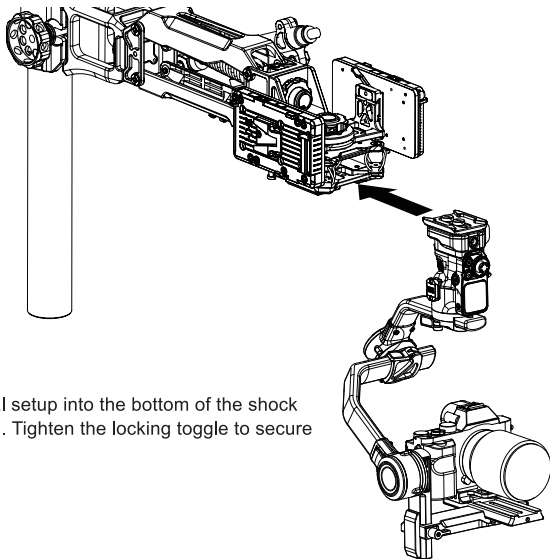

Slide the gimbal setup into the bottom of the shock absorbing head. Tighten the locking toggle to secure the gimbal.

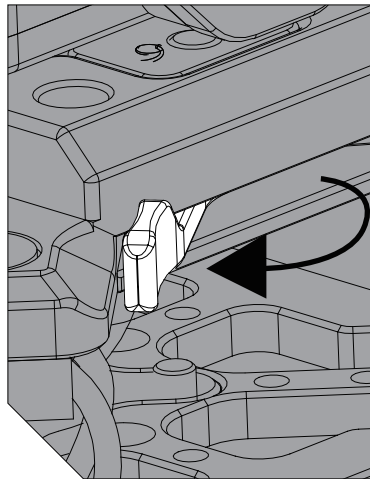

33

ADJUSTING RESISTANCE & DAMPING OF THE SHOCK ABSORBING ARM

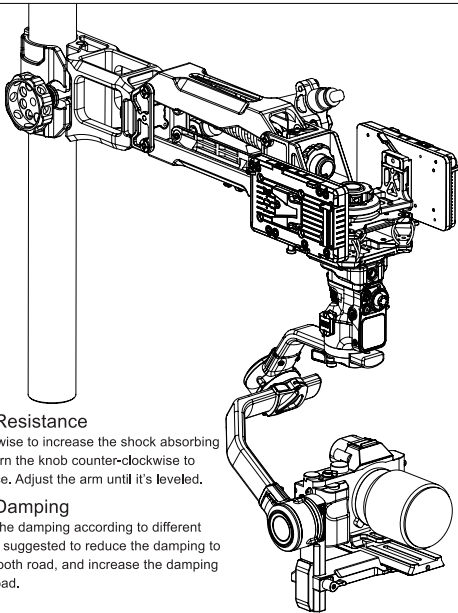

Adjusting the Resistance

Turn the knob clockwise to increase the shock absorbing arm's resistance; Turn the knob counter-clockwise to reduce the resistance. Adjust the arm until it's leveled.

Adjusting the Damping

Increase or reduce the damping according to different road conditions. It is suggested to reduce the damping to the minimum on smooth road, and increase the damping when on a bumpy road.

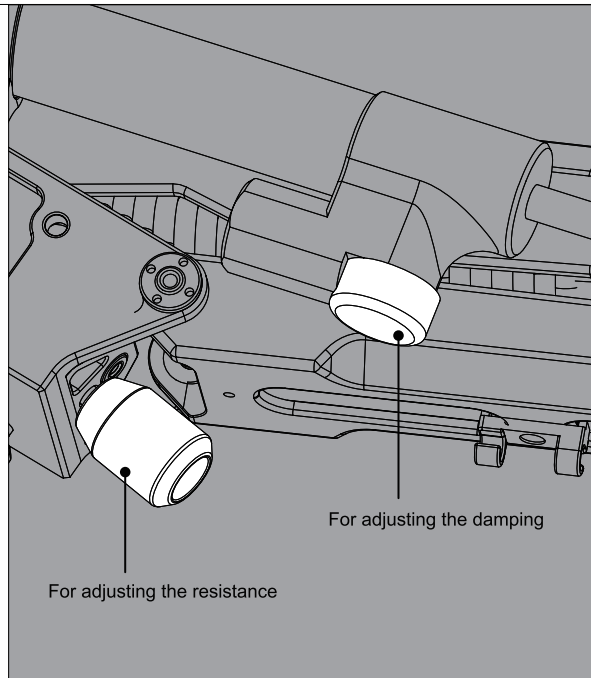

34

MOUNTING BRACKET FUNCTIONS

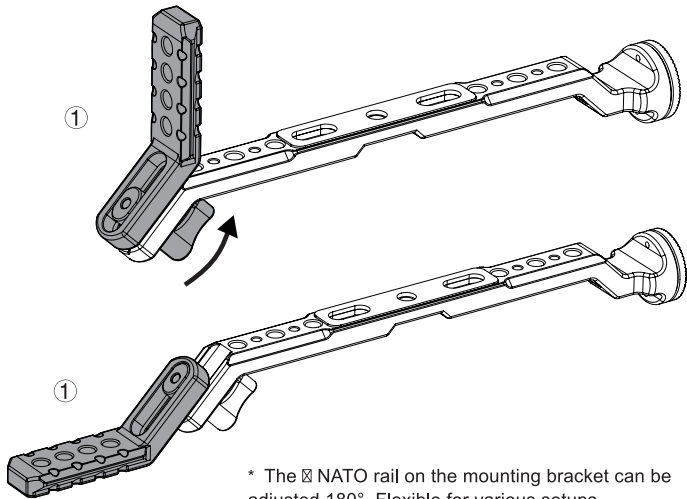

* The NATO rail on the mounting bracket can be adjusted 180°. Flexible for various setups.

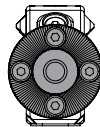

ARRI standard rosette (right)
For mounting expansions such as the Tilta Remote Control Handle for RS 2, etc.

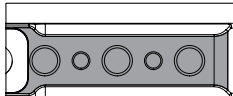

1/4"-20 threaded hole with locating points (top)
For mounting accessories

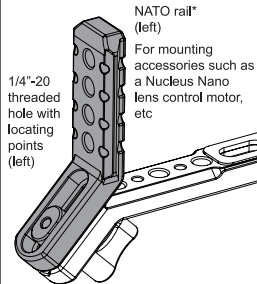

NATO rail* (left)
For mounting accessories such as a Nucleus Nano lens control motor, etc



1/4"-20 threaded hole (middle of the top)
For mounting monitor or phone holder

Anti-slip pads (top)
Protects the gear from scratches and adds more security



Sliding adjustment (bottom)
Slides forward and backward for mounting wireless video unit.

35

INSTALLING ADJUSTABLE V-MOUNT BATTERY BRACKET

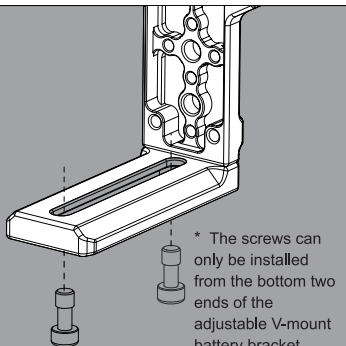

* The screws can only be installed from the bottom two ends of the adjustable V-mount battery bracket.

1. Install the adjustable V-mount battery bracket to the mounting bracket using the 1/4"-20 screws. It's compatible with mounting accessories such as an on-board monitor, V-mount battery, etc.

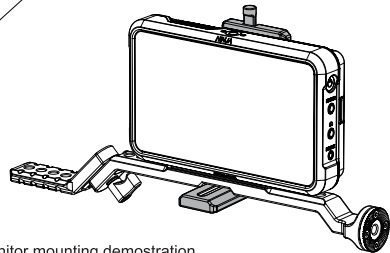
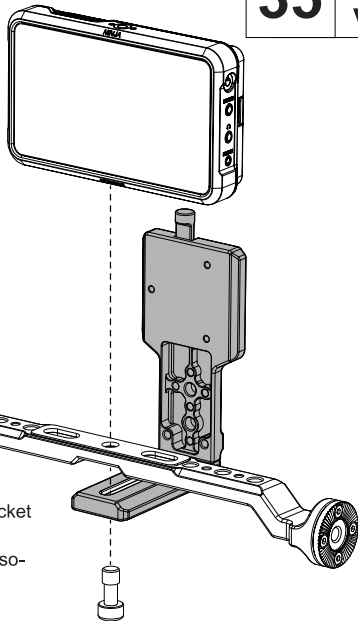

2. Monitor mounting demonstration.
(Maximum monitor size is 7")

3. V-mount battery can be mounted on the back of the adjustable V-mount battery bracket to power a wireless video unit or on-board monitor.

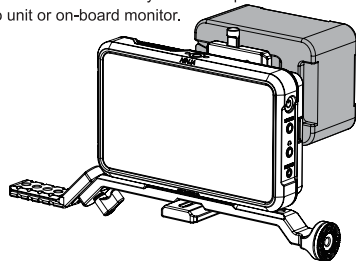

36

INSTALLING PHONE HOLDER

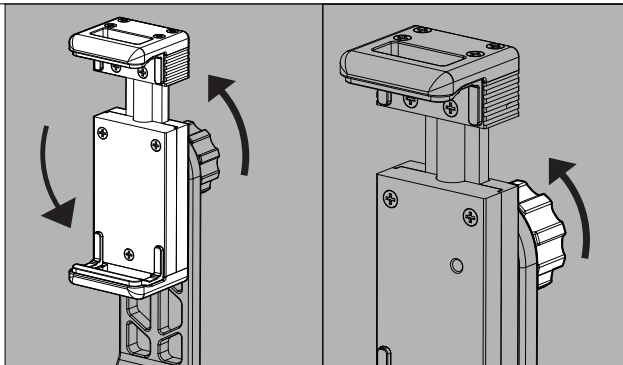
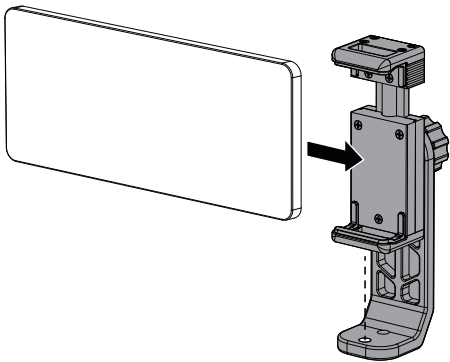

2. The phone holder can be adjusted 360° for operating needs.

3. Tighten the tie down after adjusting the bracket to the desired position.

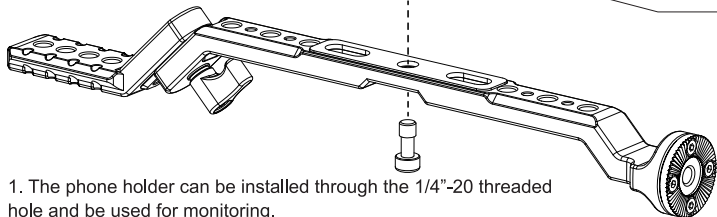

1. The phone holder can be installed through the 1/4"-20 threaded hole and be used for monitoring.

37

WORKING WITH HYDRA ALIEN MONITOR BRACKET

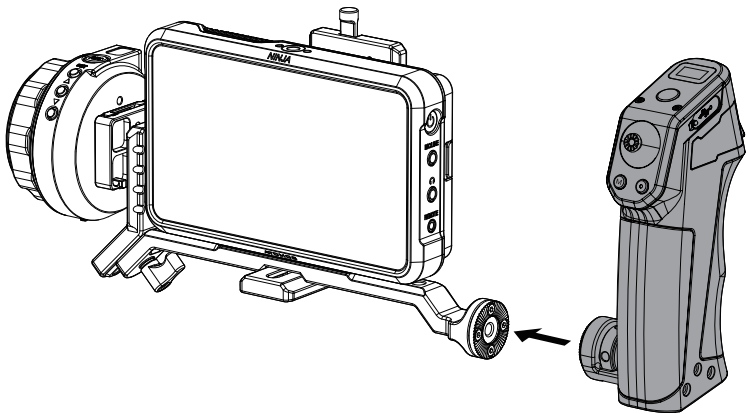

Hydra Alien Monitor Mounting Bracket - A custom design for RS 2 gimbal car mount setup

1. To achieve remote control and real time monitoring, attach the remote control handle to the monitor bracket through the rosette adapter. Tighten the tie down.

OTHER ASSEMBLIES

2. For follow focus control, use the Hydra Alien Monitor Bracket with the Tilta Nucleus-Nano lens control system.

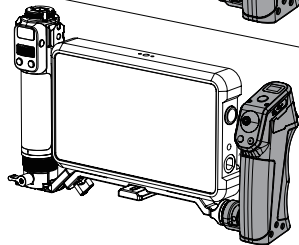
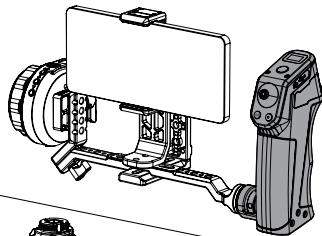

3. For focus/zoom control, use the Hydra Alien Monitor Bracket with the Dual Channel Wireless Lens Control Handle.

38

INSTALLING 18650 BATTERY PACK (OPTIONAL)

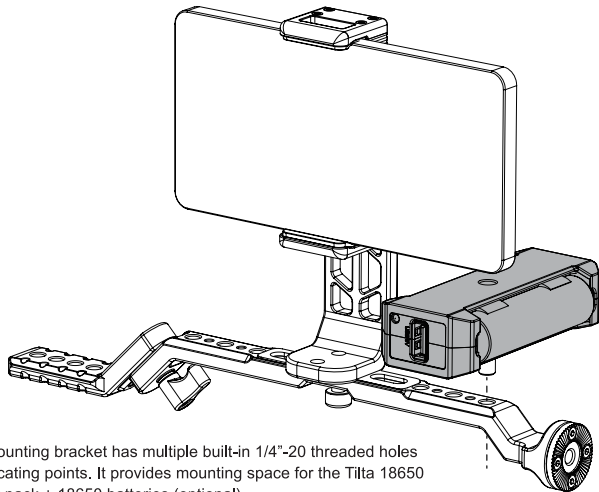
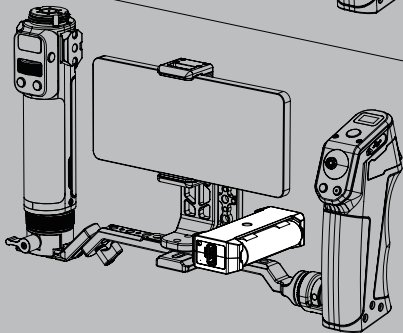
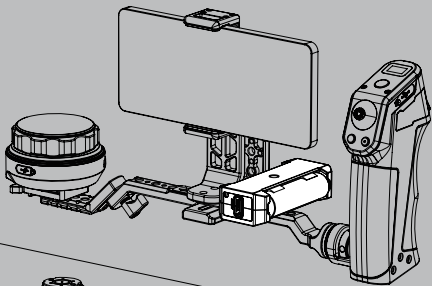

The mounting bracket has multiple built-in 1/4"-20 threaded holes with locating points. It provides mounting space for the Tilta 18650 battery pack + 18650 batteries (optional).

* The 18650 battery pack has 5V USB and 8V DC power outputs. Please check the voltage of your equipment before plugging in to avoid any possible damage.

39

REMOTE CONTROL HANDLE OVERVIEW

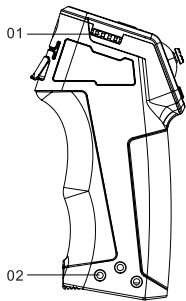

SIDE

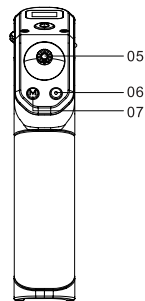
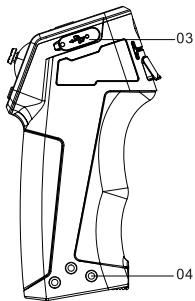

FRONT

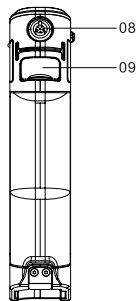

BACK

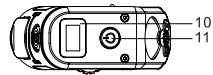

TOP

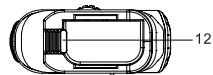

BOTTOM

01. Side wheel

02. Expansion mounting hole

03. USB port

04. Expansion mounting hole

05. Joystick

06. Camera control button

07. M button

08. LEMO port

09. Trigger

10. Display

11. Power button

12. Battery release

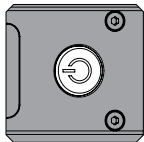
**POWER BUTTON**

3 seconds hold: Power on
 Single click: Switch interface
 Double click: Gimbal sleep mode
 Double click again: Wake up the gimbal
 Triple click: Menu settings

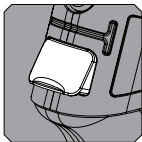
**TRIGGER**

Single click: Start smart following (wireless video system not activated)
 Double click: Reset gimbal
 Triple click: Selfie mode
 Hold: Lock mode

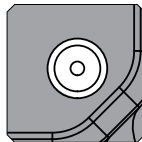
**CAMERA CONTROL BUTTON**

Half way hold: Auto focus control
 Quick click: Start/stop recording
 Long hold: Take photos

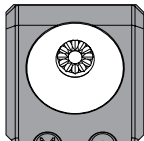
**JOYSTICK**

Up & down: Control tilt (default setting)
 Left & right: Control pan (default setting)

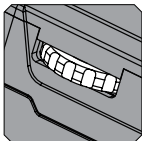
**SIDE WHEEL**

Turn the wheel clockwise to speed up the gimbal movement. Turn the wheel counter-clockwise to slow down the gimbal movement.

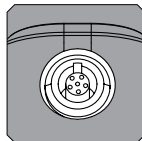
**LEMO PORT**

To control the gimbal, connect the 6-pin LEMO port and the remote control receiver module via the 6-pin LEMO cable.

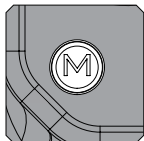
**M BUTTON**

Single click: Switch gimbal modes.
 Double click: Vertical mode. Double click again to exit the vertical mode.
 Triple click: 360 mode. Repeat triple click to exit 360 mode, pressing the joystick twice either left or right will make the camera spin automatically. Double click trigger to stop this action.
 Long hold: Sport mode. Holding while double-clicking the trigger will lock the sport mode (no need to hold too long). Repeat the same action to exit the sport mode.

41

REMOTE CONTROL HANDLE ASSEMBLY

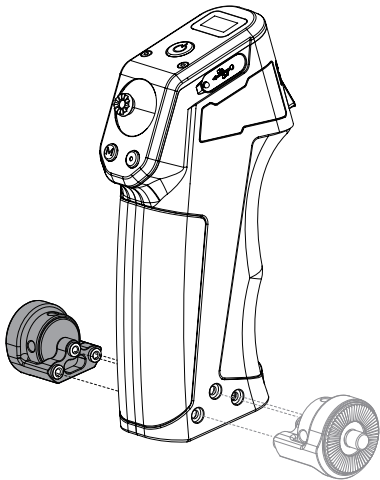

* The remote control handle comes with one standard rosette adapter. It can be mounted on either side of the handle.

1. Installing  rosette adapter.

Install the rosette adapter on the side expansion mounting holes to work with other accessories.

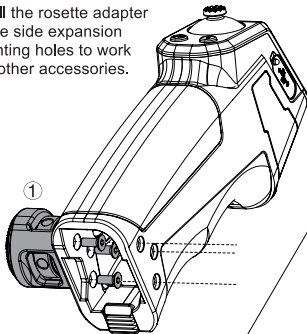

2. Installing  battery (F550/F570 battery is not included)

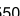
Insert  F550/F570 battery and power on the handle.

(Remote control receiver module is required to work with the handle.)

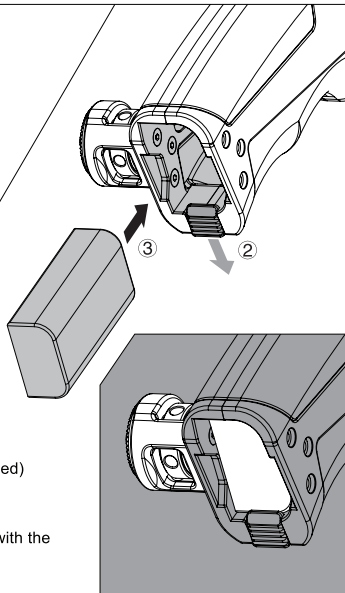

42

PAIRING THE REOMOTE CONTROL HANDLE FOR WIRELESS REMOTE OPERATION

Hold M button and record key at the same time to quickly enter auto-search mode. Then double-click the button on the remote control receiver module. The indicator light will blink red. When the remote control handle is connected, the indicator on the receiver module will turn green. Once the pairing is done, you will be able to control the gimbal wirelessly from the handle. The maximum control distance is 80m.

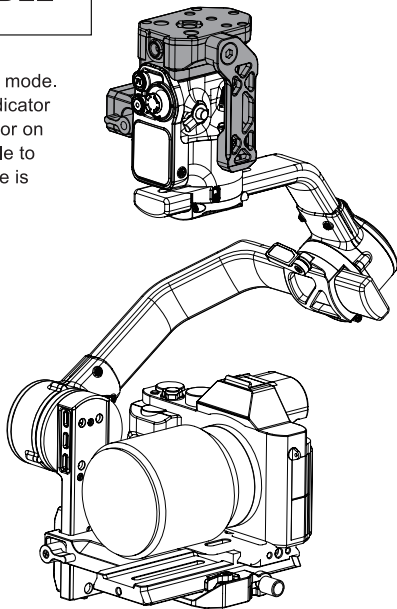
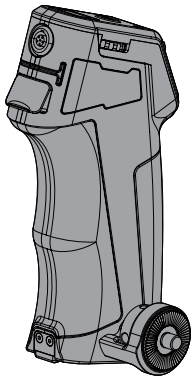

43

USE 6-PIN LEMO TO 6-PIN LEMO CABLE FOR PRECISE CONTROL

The handle has a built-in 6-pin LEMO port (13-17v) for power supply. For more precise control, connect the 6-pin LEMO port on the handle to the remote control receiver module with the 6-pin LEMO to 6-pin LEMO cable.

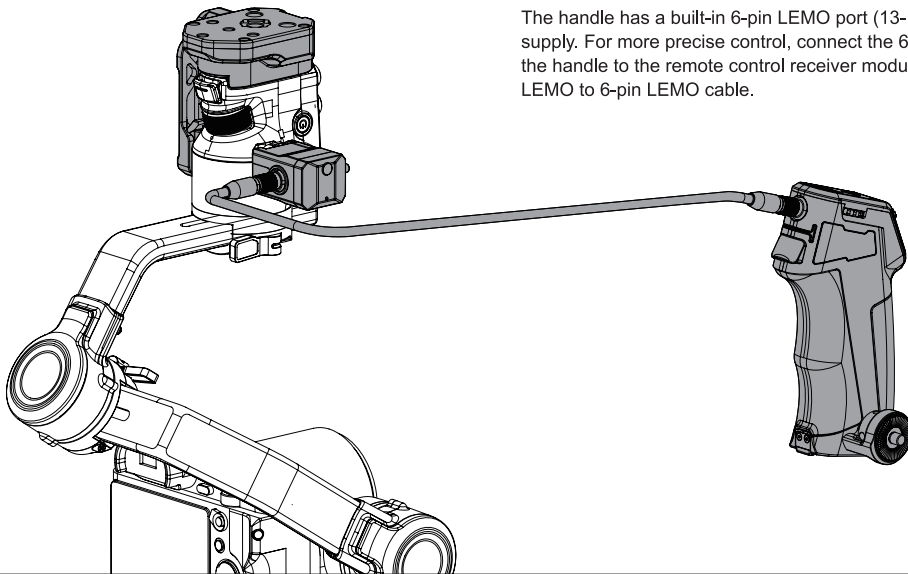

Long Hold Power Button: Enter the menu settings

Single Click Power Button: Back to the main menu

Double Click Power Button: Gimbal sleep mode

Enter Menu Settings: To confirm, press M key. To return to the previous menu, press the camera control key. To move up and down, push the joystick up and down. To quickly select, hold the joystick for 3 seconds.

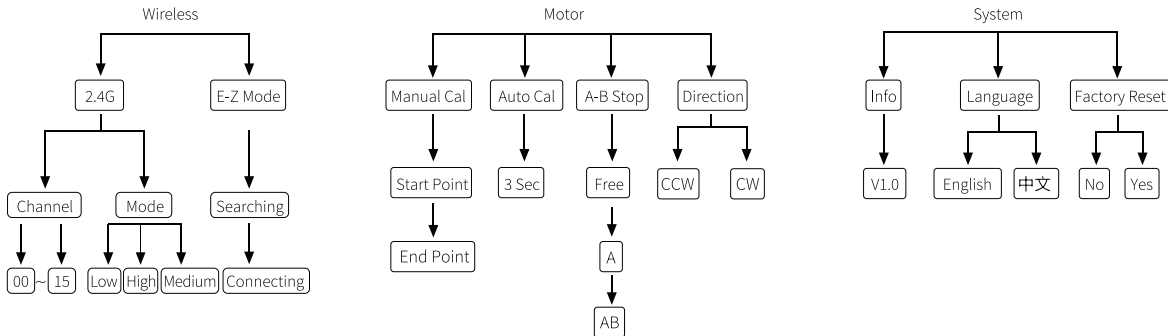

TILTA

版权由深圳铁头科技有限公司所有

需授权方可转载

本公司有权在不提前通知的情况下修改产品参数

TILTA 是深圳铁头科技有限公司的注册商标

官方网站: tilta.com.cn www.tilta.com

中国地址: 深圳市光明新区光侨路转7号路 侨德高新科技园B栋2楼

全国服务热线: 4006 1998 67

All copyrights belong to Tilta Technology Co. Ltd.

Written permission is needed for any reproductions.

Tilta has the right to adjust product specification without notice.

TILTA is a registered trademark owned by Tilta Technology Co., Ltd.

Website: www.tilta.com

US Address: 2801 W Magnolia Blvd, Burbank, CA 91505

US Contact Number: +1(818)651-4991



关注微信公众号



扫码进入官网